

DEPOSITO DE MATERIAL EXCEDENTE  
D.M.E. "Km 49+640"  
LADO IZQ.

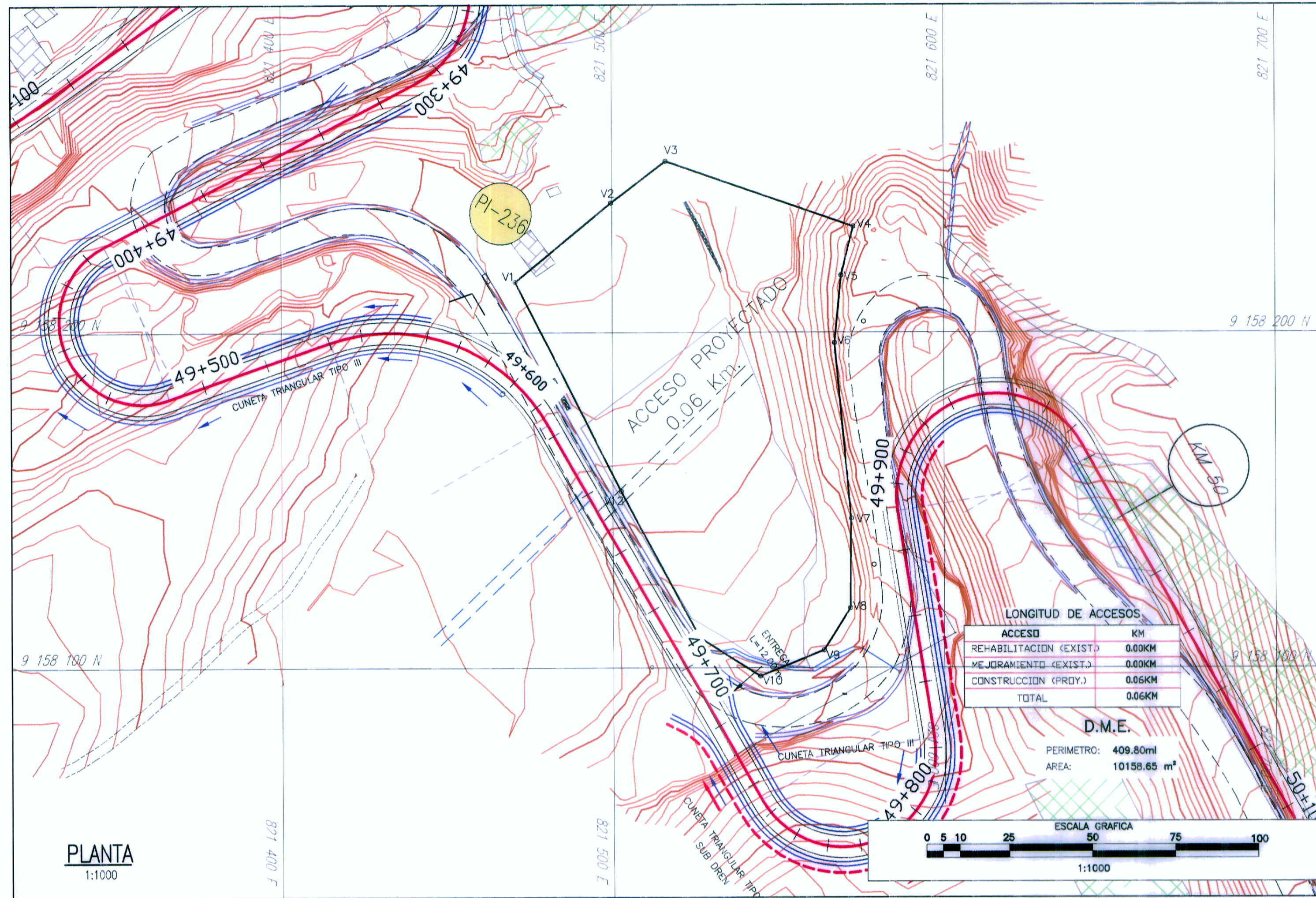

CALCULO DE CAPACIDAD

PROGRESIVAS	AREA m <sup>2</sup>	VOLUMEN m <sup>3</sup>
49+600	468.62	
49+610	417.27	4429.45
49+620	823.32	6202.95
49+630	749.00	7861.60
49+640	654.99	7019.95
49+650	620.50	6377.45
49+660	541.53	5810.15
49+670	468.91	5052.20
49+680	399.40	4341.55
49+690	289.86	3446.30
49+700	235.53	2626.95
49+710	128.89	1822.10
<b>TOTAL</b>		<b>54990.65</b>

CUADRO DE COORDENADAS

PUNTO	NORTE	ESTE
1	9158215.25	821470.74
2	9158238.93	821499.71
3	9158251.43	821516.16
4	9158231.74	821572.71
5	9158217.13	821568.97
6	9158196.81	821566.96
7	9158144.67	821571.91
8	9158117.84	821571.60
9	9158105.22	821563.64
10	9158097.43	821544.36
11	9158108.96	821526.17
12	9158152.92	821502.49

PLANTA  
1:1000

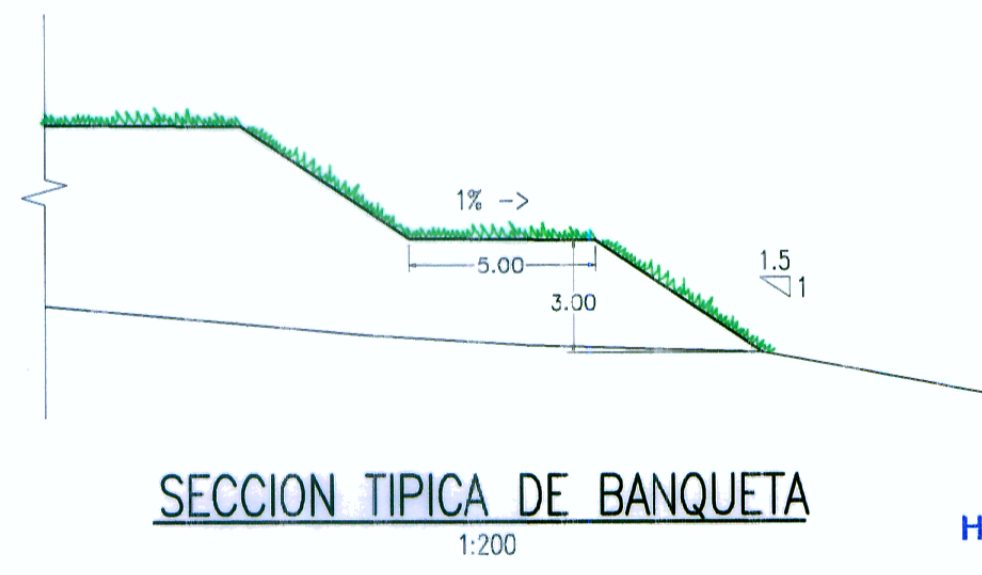
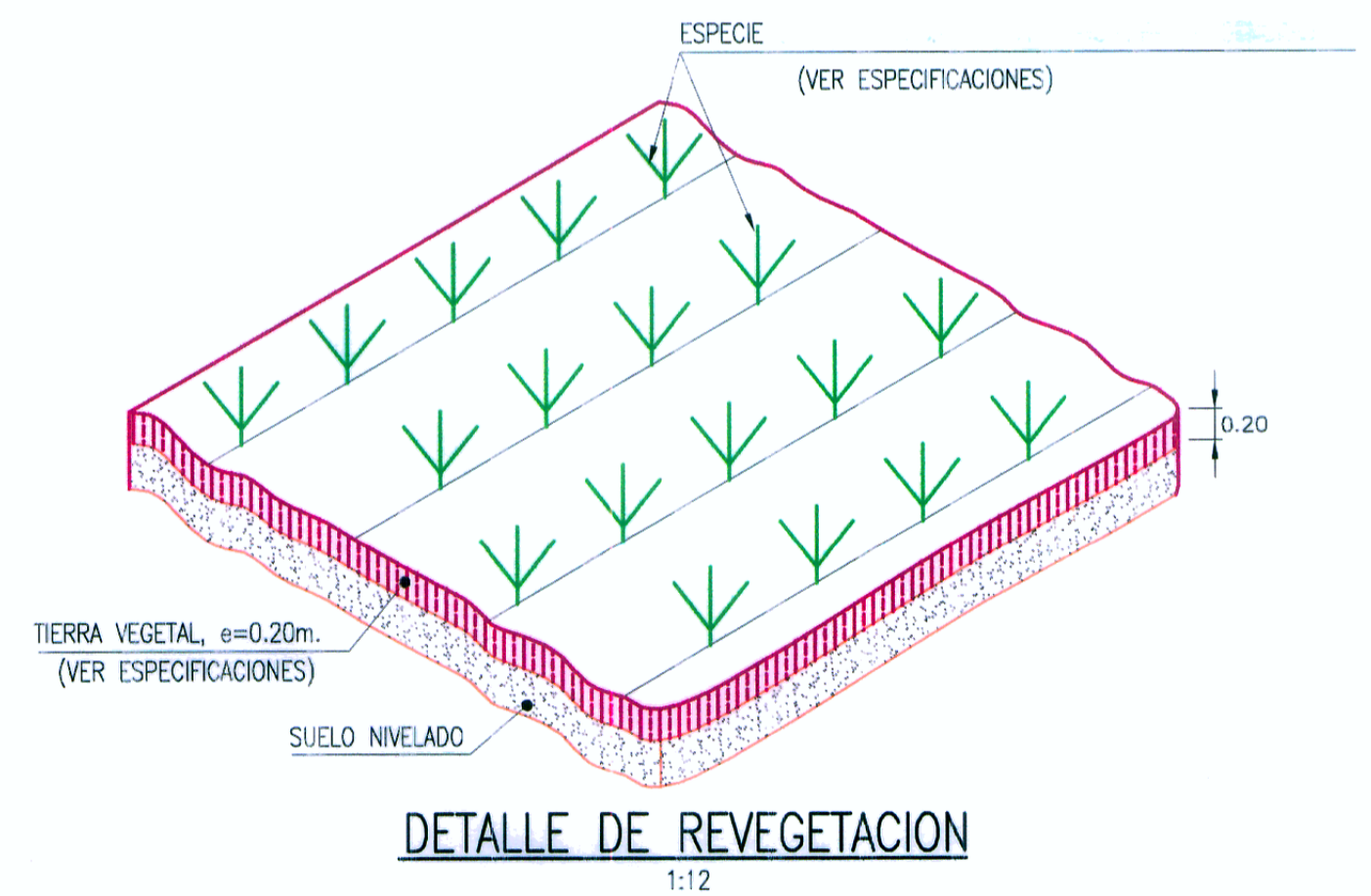

LEYENDA

PLANTA :

- EJE PROYECTADO
- CARRETERA EXISTENTE
- CURVA MAYOR
- CURVA MENOR
- CASA

MATERIAL EXCEDENTE :

- VERTICE DE POLIGONAL
- AREA DE BOTADERO

HOB CONSULTORES S.A.  
ING. FERNANDO MANUEL VALDIVIA VARGAS  
ESP. IMPACTO AMBIENTAL  
CIP N° 64157

REVISIONES

N°	FECHA	DESCRIPCION