

PLANO DE AREA REMANENTE Escala: 1/1000

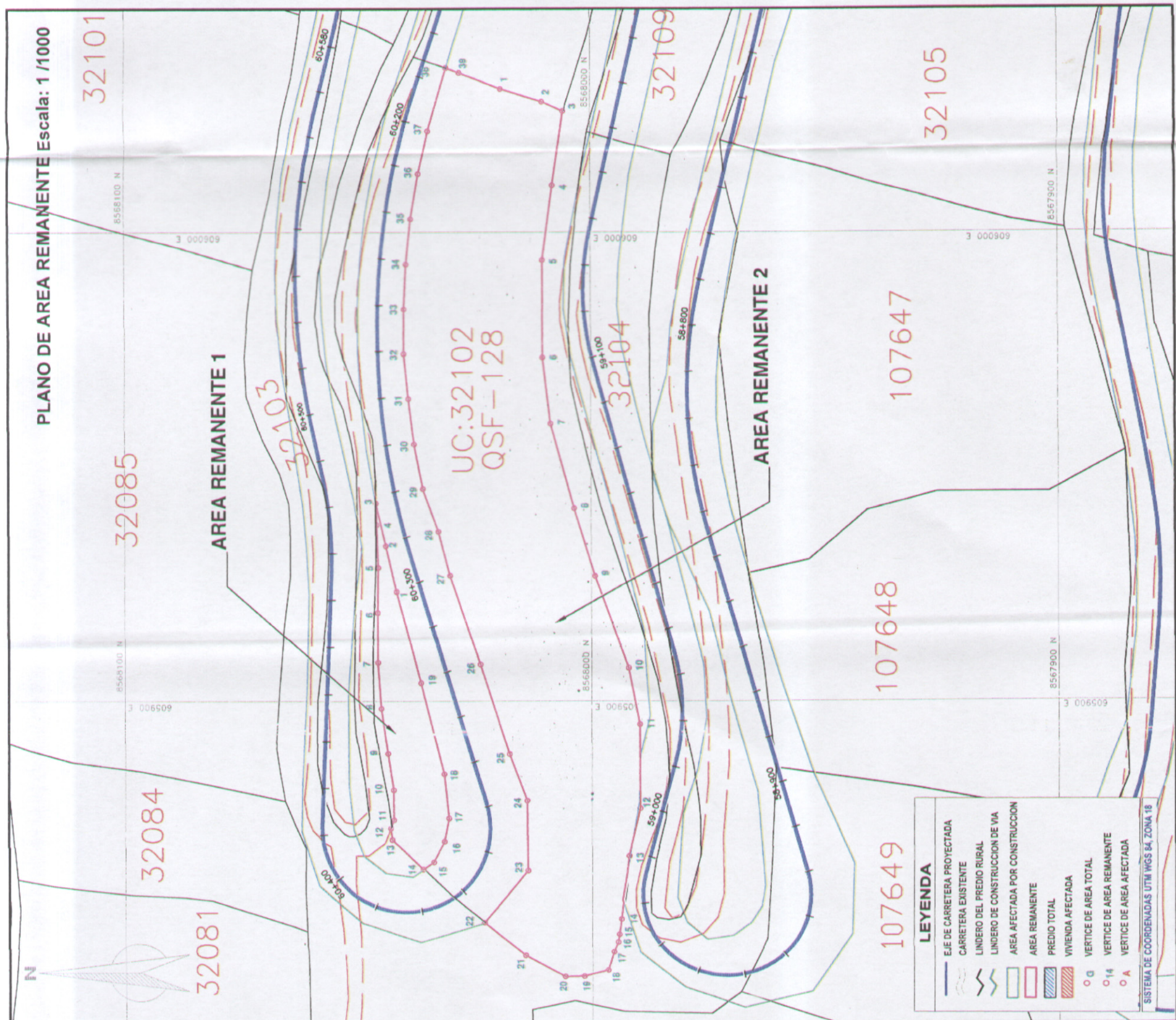

CUADRO DE DATOS TECNICOS AREA REMANENTE 1

VERTICE	LADO	DISTANCIA	ESTE (X)	NORTE (Y)
1	1-2	10.16	605922.0861	8568041.4760
2	2-3	8.37	605932.8842	8568043.7644
3	3-4	4.61	605842.1137	8568045.8605
4	4-5	9.20	605837.3587	8568045.7319
5	5-6	9.69	605828.3121	8568045.4134
6	6-7	10.54	605818.8263	8568045.5882
7	7-8	9.76	605808.0853	8568045.5325
8	8-9	9.67	605808.3312	8568044.8335
9	9-10	7.92	605808.9411	8568044.4013
10	10-11	6.40	605808.9411	8568042.2216
11	11-12	1.90	605817.5425	8568042.1903
12	12-13	2.42	605822.7686	8568043.8755
13	13-14	9.19	605870.3867	8568042.5851
14	14-15	2.70	605864.0145	8568035.9246
15	15-16	5.00	605865.5237	8568033.6808
16	16-17	5.00	605869.9634	8568031.3851
17	17-18	9.52	605874.8715	8568030.4155
18	18-19	20.02	605884.3483	8568031.3674
19	19-1	20.01	605903.7506	8568036.3125

CUADRO DE DATOS TECNICOS AREA REMANENTE 2

VERTICE	LADO	DISTANCIA	ESTE (X)	NORTE (Y)
1	1-2	9.31	606030.8130	8568018.6556
2	2-3	4.93	606028.0291	8568010.0737
3	3-4	18.40	606026.0522	8568005.5523
4	4-5	15.96	606008.8206	8568007.8812
5	5-6	21.03	605984.0091	8568010.0503
6	6-7	14.18	605972.9791	8568010.2858
7	7-8	18.57	605958.9003	8568008.3561
8	8-9	15.20	605941.0137	8568003.3738
9	9-10	20.84	605926.4667	8567998.6538
10	10-11	12.21	605906.9017	8567981.7903
11	11-12	17.99	605894.9233	8567969.4320
12	12-13	10.44	605876.9833	8567969.3797
13	13-14	13.73	605866.8017	8567961.7937
14	14-15	3.49	605863.1702	8567963.4333
15	15-16	1.78	605849.7102	8567963.9009
16	16-17	2.36	605847.9500	8567964.1797
17	17-18	4.31	605845.7694	8567965.0882
18	18-19	5.30	605841.8485	8567966.3554
19	19-20	4.12	605840.2850	8568001.4744
20	20-21	9.72	605840.2222	8568003.5644
21	21-22	11.49	605845.0263	8568014.0477
22	22-23	14.70	605832.3998	8568022.8613
23	23-24	14.90	605805.7531	8568013.4864
24	24-25	10.68	605878.6331	8568017.3659
25	25-26	20.00	605888.6346	8568023.5927
26	26-27	20.01	605907.6446	8568023.5927
27	27-28	9.79	605926.5864	8568030.0421
28	28-29	9.69	605936.0570	8568032.5224
29	29-30	9.64	605945.1469	8568035.8043
30	30-31	9.65	605954.6295	8568037.6666
31	31-32	8.87	605964.1842	8568038.8445
32	32-33	9.87	605973.8016	8568039.8418
33	33-34	9.67	605983.4715	8568039.7775
34	34-35	9.67	605993.1252	8568039.2979
35	35-36	9.68	606002.7464	8568036.2531
36	36-37	9.68	606012.2848	8568036.8209
37	37-38	14.13	606021.7341	8568034.5070
38	38-39	3.00	606035.3341	8568030.6650
39	39-1	9.55	606054.3268	8568027.8390

CUADRO RESUMEN

AREA DE PREDIO:	8441.39 m ²
AREA AFECTADA TOTAL:	2090.92 m ²
AREA REMANENTE 1:	564.84 m ²
AREA REMANENTE 2:	5389.50 m ²
AREA REMANENTE TOTAL:	5954.34 m ²
PERIMETRO PREDIO:	452.44 m
PERIMETRO REMANENTE 1:	163.10 m
PERIMETRO REMANENTE 2:	437.08 m
PERIMETRO AFECTADO:	394.57 m
CENTROIDE ESTE:	605944.36 m
CENTROIDE NORTE:	8568022.51 m

CONSORCIO WARI
ROGELIO JIROZ CHAVEZ
 REPRESENTANTE LEGAL

CONSORCIO WARI
 Ing. Willy Alicairna Crisostomo
 Esp en Afectaciones Prediales
 C.I.P 97040

CONSORCIO WARI
 Ing. Ricardo Gozales Cangalaya
 Jefe del Estudio
 CIP N° 2284

LEYENDA

	EJE DE CARRETERA PROTEGIDA
	CARRETERA EXISTENTE
	LINDERO DEL PREDIO RURAL
	LINDERO DE CONSTRUCCION DE VIA
	AREA AFECTADA POR CONSTRUCCION
	AREA REMANENTE
	PREDIO TOTAL
	VIVIENDA AFECTADA
	VERTICE DE AREA TOTAL
	VERTICE DE AREA REMANENTE
	VERTICE DE AREA AFECTADA

CONTRATO DE SERVICIOS DE CONSULTORIA N° 236-2008-UT/02

ESTUDIO DEFINITIVO PARA LA REHABILITACION Y MEJORAMIENTO DE LA CARRETERA QUINUA - SAN FRANCISCO, TRAMO : KM 26+000 - KM 78+500

FECHA: FEBRERO 2010

INDICADA: 236-08-QSF-128A

PREPAREDADO POR: ALEJANDRO LARA QUISEP

CONSORCIO WARI S.A.

WAWARO VEH S.A.

PERU Ministerio de Transportes y Comunicaciones

Viceministerio de Transportes y Comunicaciones

Provincia Nacional