

407

CUADRO DE DATOS TECNICOS
AREA REMANENTE 1

VERTICE	LADO	DISTANCIA	ESTE (X)	NORTE (Y)
1	1-2	1.11	609871.6925	8568453.9085
2	2-3	1.11	609871.0815	8568453.9760
3	3-4	1.11	609870.5075	8568453.0368
4	4-5	1.11	609869.9407	8568451.0855
5	5-6	1.11	609869.3911	8568450.1242
6	6-7	1.11	609868.8629	8568448.1520
7	7-8	1.11	609868.3442	8568446.1327
8	8-9	1.11	609867.8934	8568444.1136
9	9-10	1.11	609867.4814	8568442.1319
10	10-11	1.11	609866.9875	8568440.1384
11	11-12	1.11	609866.5119	8568438.1335
12	12-13	1.11	609866.0657	8568436.1137
13	13-14	1.12	609865.7419	8568434.0502
14	14-15	1.12	609865.4242	8568431.0445
15	15-16	1.07	609865.1656	8568428.9800
16	16-17	1.35	609864.8659	8568426.9127
17	17-18	6.74	609861.3487	8568440.3682
18	18-19	14.50	609861.3002	8568433.6281
19	19-20	15.73	609848.8467	8568434.7977
20	20-21	5.0	609850.0687	8568450.1846
21	21-22	13.38	609849.4950	8568450.2811
22	22-23	12.66	609853.8182	8568462.0743
23	23-24	10.32	609863.3125	8568472.2734
24	24-25	7.49	609873.2198	8568485.3874
25	25-26	6.45	609880.4139	8568467.2918
26	26-27	8.9	609885.8142	8568468.0693
27	27-28	1.11	609885.0500	8568467.6170
28	28-29	1.11	609885.1059	8568467.0237
29	29-30	1.11	609884.1787	8568466.4055
30	30-31	1.11	609883.2689	8568465.7629
31	31-32	1.11	609882.3773	8568465.0863
32	32-33	1.11	609881.5045	8568464.4264
33	33-34	1.11	609880.6748	8568463.6645
34	34-35	1.11	609879.8873	8568462.9003
35	35-36	1.11	609879.1496	8568462.1187
36	36-37	1.11	609878.2878	8568461.3461
37	37-38	1.11	609877.4375	8568460.6355
38	38-39	1.11	609876.6084	8568459.9002
39	39-40	1.11	609875.7854	8568458.1502
40	40-41	1.11	609875.0817	8568456.3989
41	41-42	1.11	609874.4286	8568457.3699
42	42-43	1.11	609873.7094	8568456.5492
43	43-44	1.11	609873.0170	8568455.6800
44	44-1	1.11	609872.3382	8568454.8094

CUADRO DE DATOS TECNICOS
AREA REMANENTE 2

VERTICE	LADO	DISTANCIA	ESTE (X)	NORTE (Y)
1	1-2	13.32	610009.8211	8568467.3357
2	2-3	13.97	610019.5216	8568452.0226
3	3-4	11.60	609995.8598	8568448.1228
4	4-5	4.4	609984.2717	8568446.5260
5	5-6	7.9	609984.4922	8568448.9057
6	6-7	7.9	609984.9422	8568449.5975
7	7-8	7.9	609985.1144	8568450.1009
8	8-9	7.9	609986.1020	8568450.6259
9	9-10	7.9	609986.7042	8568451.1322
10	10-11	7.8	609987.3002	8568451.6194
11	11-12	7.8	609987.9493	8568452.0874
12	12-13	8.6	609988.5985	8568452.5251
13	13-14	8.5	609989.4402	8568452.7185
14	14-15	7.6	609990.2653	8568452.9022
15	15-16	7.6	609990.8924	8568453.3301
16	16-17	7.6	609991.5304	8568453.7403
17	17-18	7.7	609992.1656	8568454.1527
18	18-19	7.7	609992.7842	8568454.6267
19	19-20	7.9	609993.3966	8568455.1491
20	20-21	1.01	609993.9297	8568455.6752
21	21-22	1.01	609994.4758	8568456.2037
22	22-23	1.01	609995.0423	8568456.8916
23	23-24	1.01	609995.6490	8568457.4990
24	24-25	1.01	609997.1561	8568458.1059
25	25-26	1.01	609997.8534	8568458.7122
26	26-27	1.01	609998.7111	8568459.3180
27	27-28	1.01	609999.5790	8568459.9232
28	28-29	10.40	610000.3873	8568460.5279
29	29-1	2.05	610007.8482	8568467.7993

CUADRO RESUMEN

AREA REMANENTE 1:	693.90 m ²
AREA REMANENTE 2:	219.07 m ²
PERIMETRO REMANENTE 1:	127.83 m
PERIMETRO REMANENTE 2:	73.69 m
CENTROIDE ESTE:	605689.23 m
CENTROIDE NORTE:	8567726.15 m

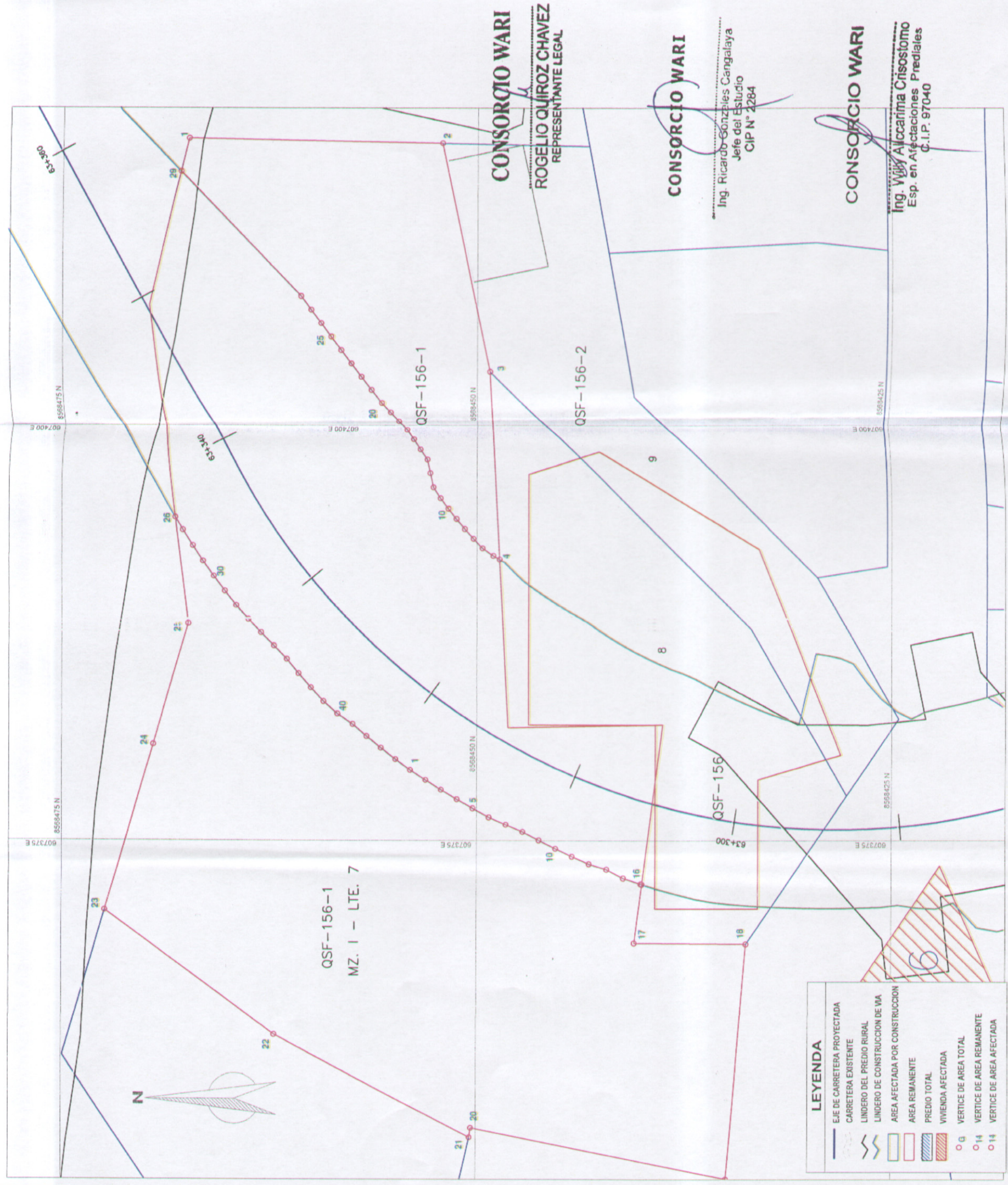

LEYENDA

- EJE DE CARRETERA PROYECTADA
- CARRETERA EXISTENTE
- LINDERO DEL PREDIO RURAL
- LINDERO DE CONSTRUCCION DE VA
- AREA AFECTADA POR CONSTRUCCION
- AREA REMANENTE
- PREDIO TOTAL
- VIVIENDA AFECTADA
- VERTICE DE AREA TOTAL
- VERTICE DE AREA REMANENTE
- VERTICE DE AREA AFECTADA

SISTEMA DE COORDENADAS UTM WGS 84 ZONA 18

PLANO DE PREDIO TOTAL Escala: 1 / 250



ESTUDIO DEFINITIVO PARA LA REHABILITACION Y MEJORAMIENTO DE LA CARRETERA QUINUA - SAN FRANCISCO, TRAMO : KM 26+500 - KM 78+500

CONTRATO DE SERVICIOS DE CONSULTORIA Nº 238 / 2008 / MTC

CONSORCIO WARI S.A.

Ministerio de Transportes y Comunicaciones

PERU

Consultor:

Revisado:

Aprobado:

INFORMACION DEL PROYECTO

INDICADA

FEBRERO 2010

238-08-QSF-156-1 VIV