

**SECCIONES TRANSVERSALES  
AGUAS ARRIBA LADO IZQUIERDO**

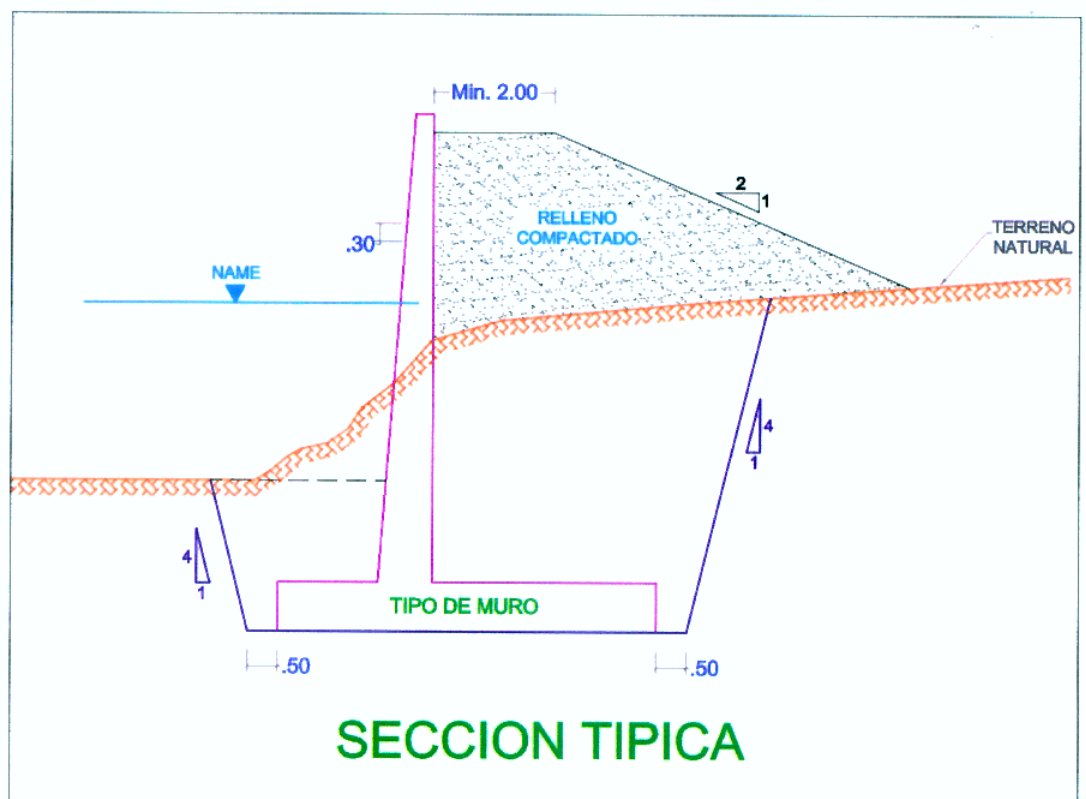

NOTA:  
LOS DETALLES DE LOS DISEÑOS  
TÍPICOS DE LOS MUROS SE  
ENCUENTRAN EN LOS PLANOS  
DE DISEÑOS TÍPICOS DM-01-10  
AL DM-10-10.

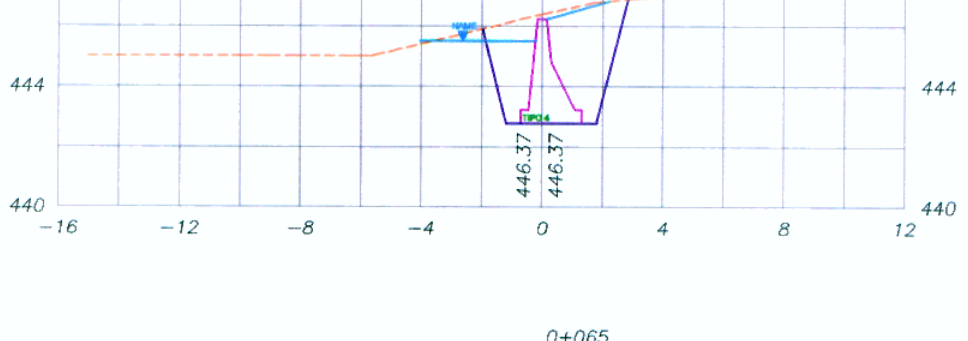
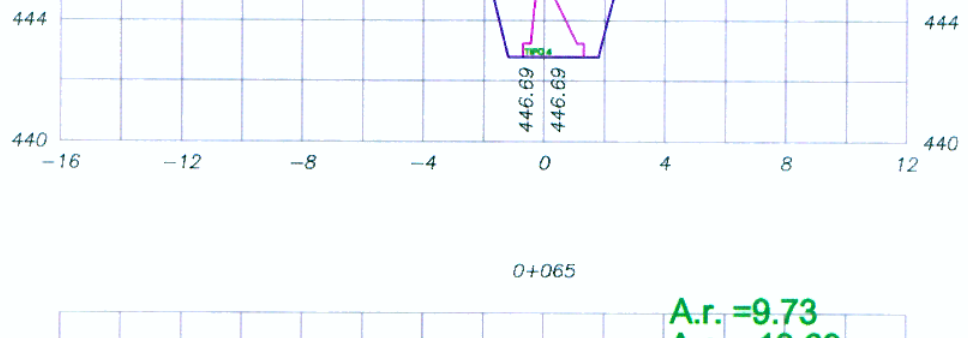
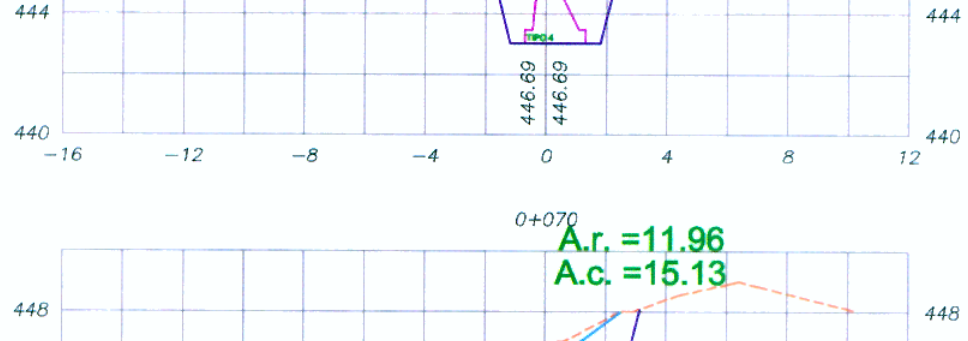
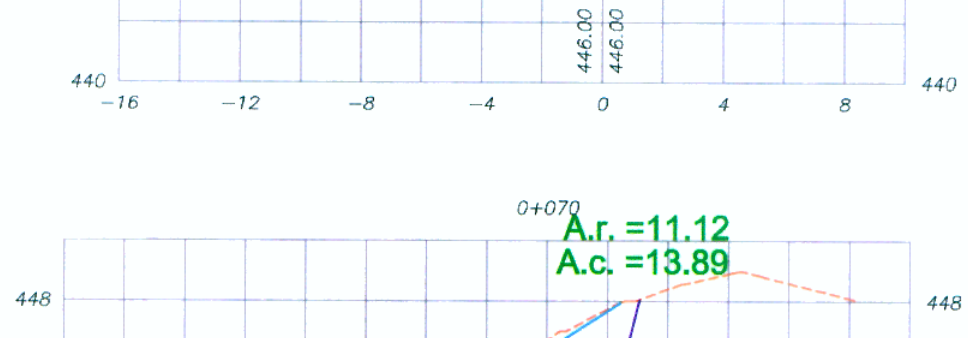
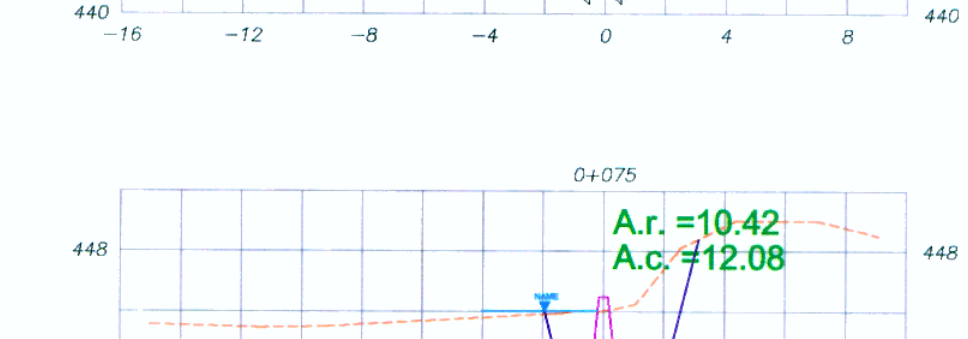
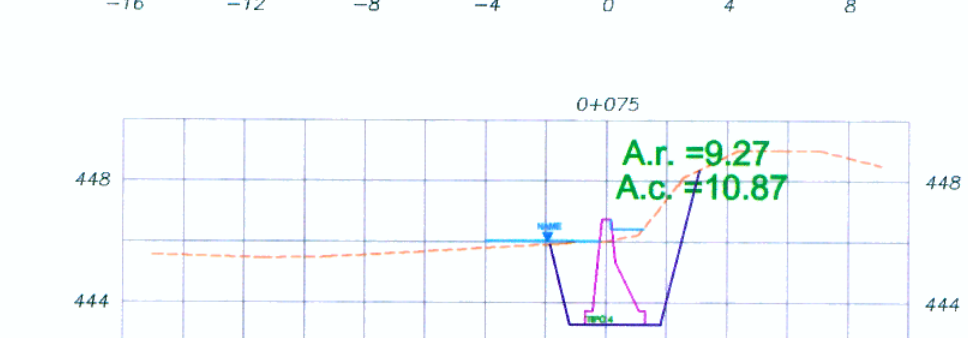
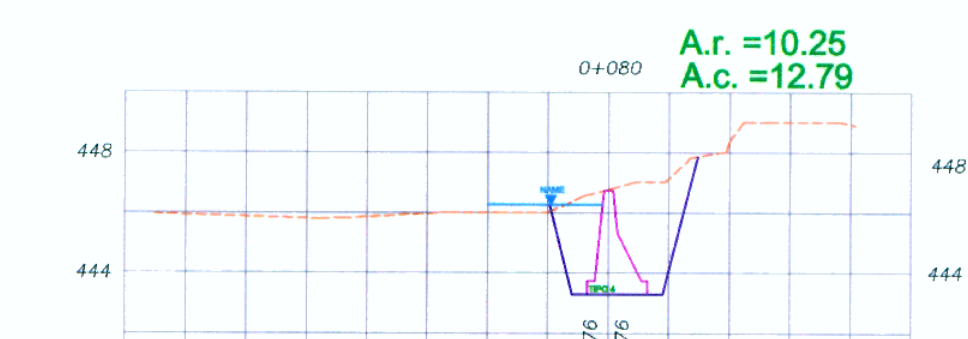
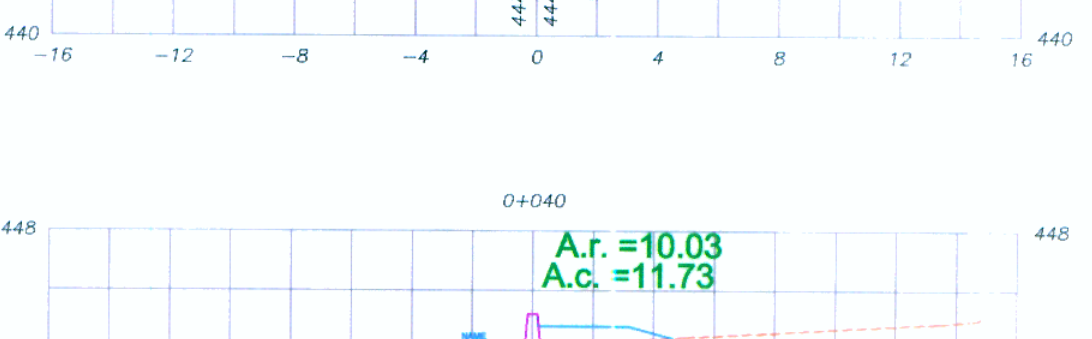
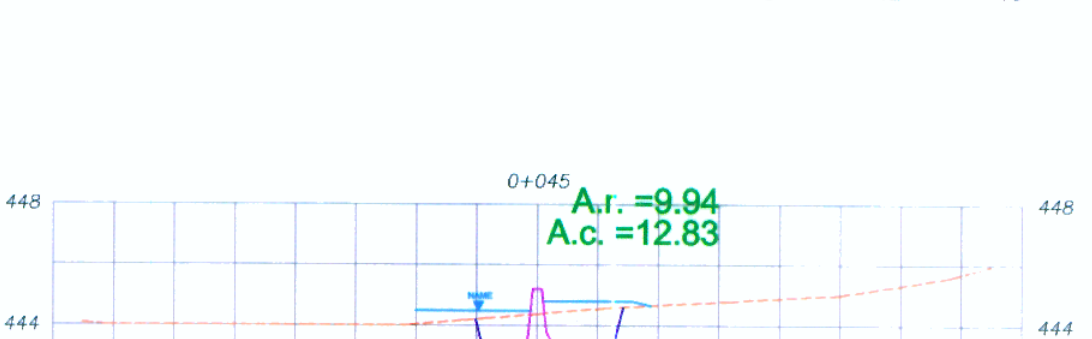
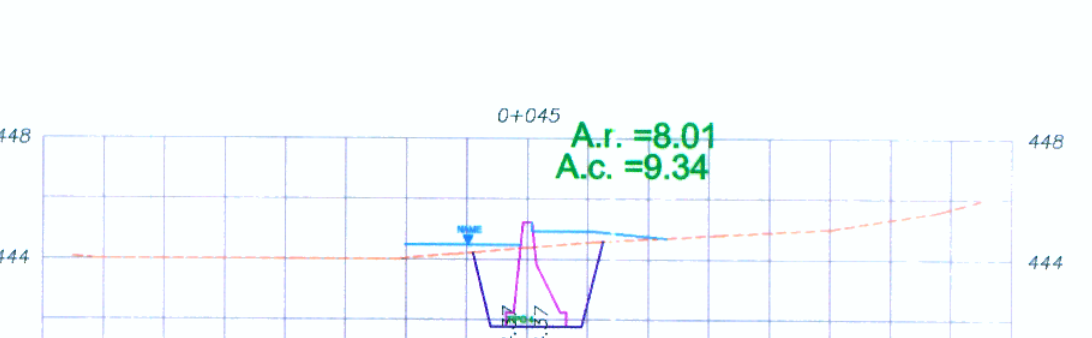
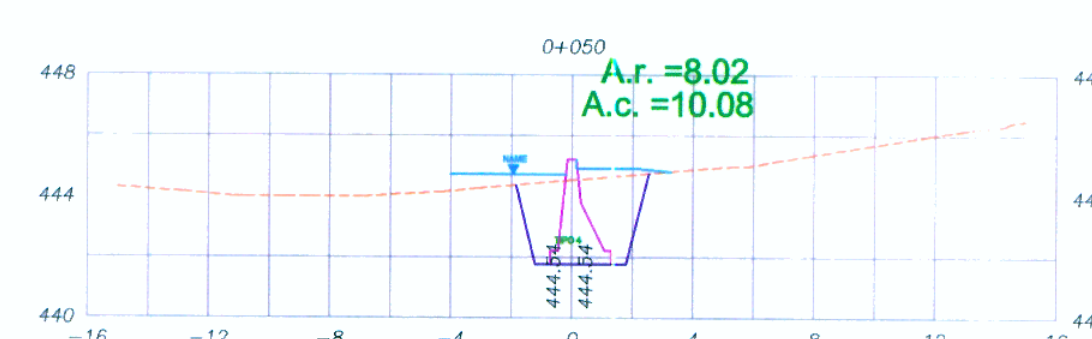
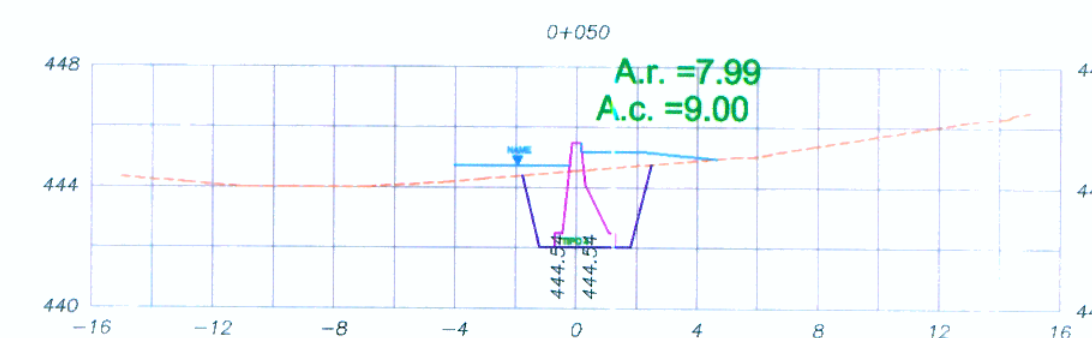
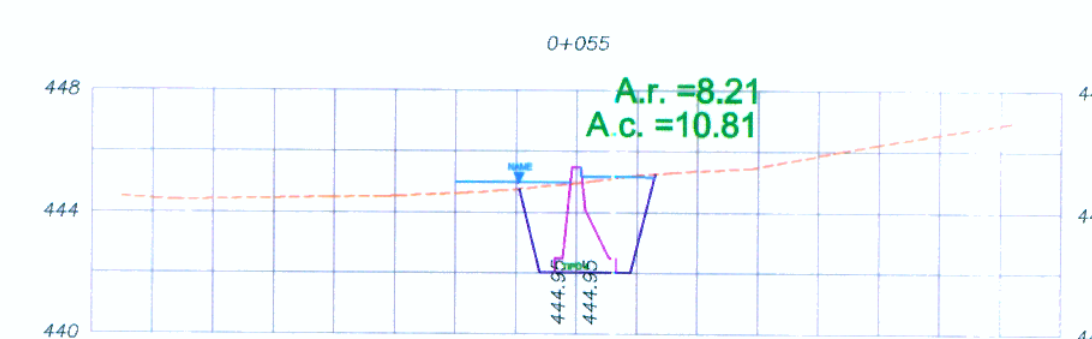
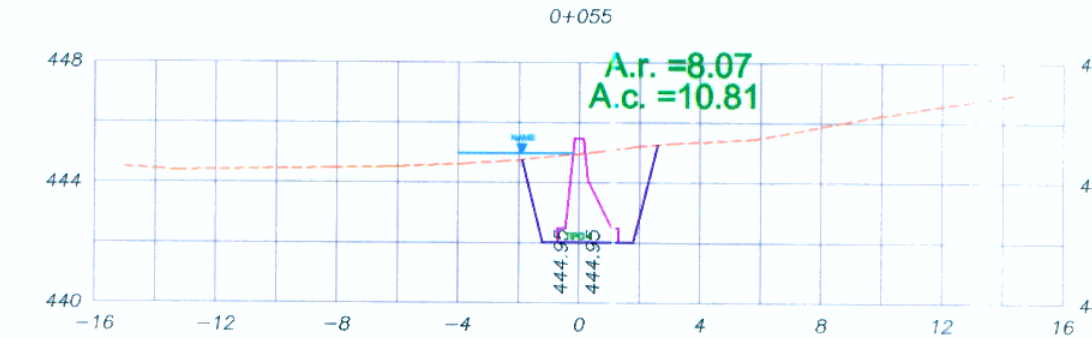
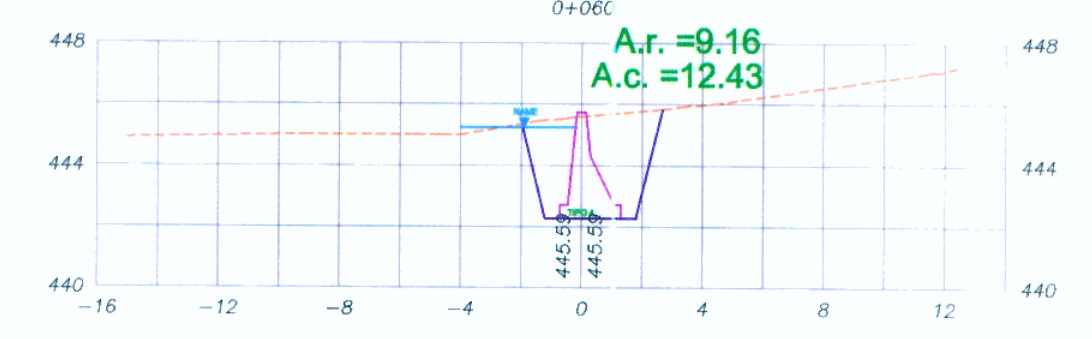
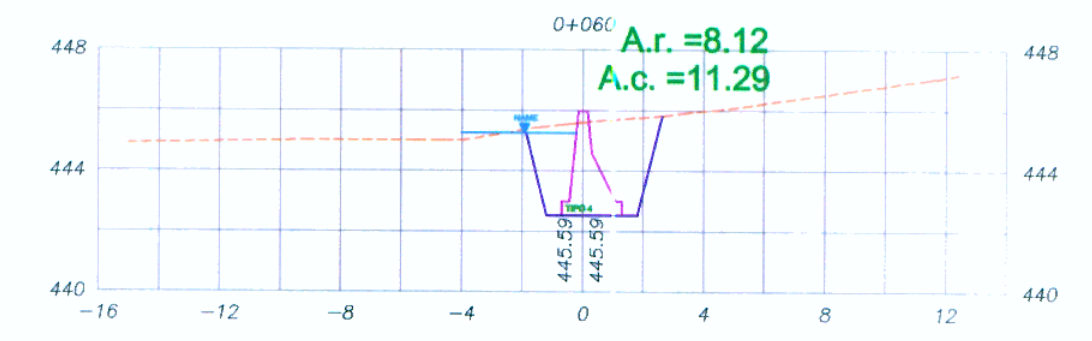
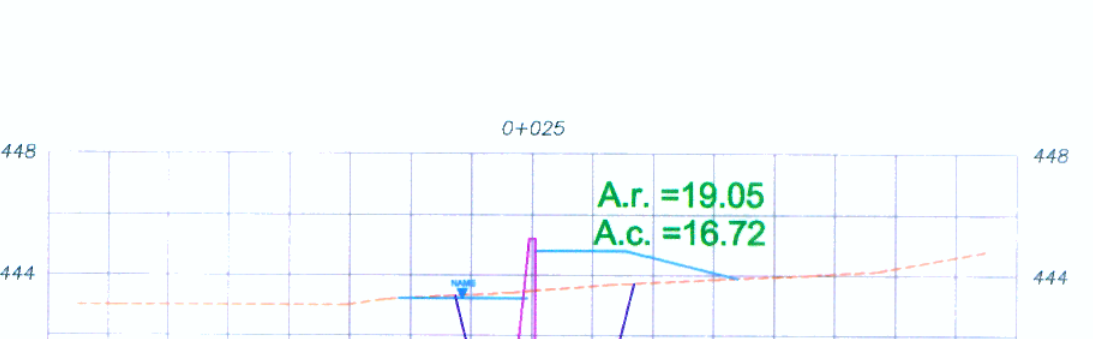
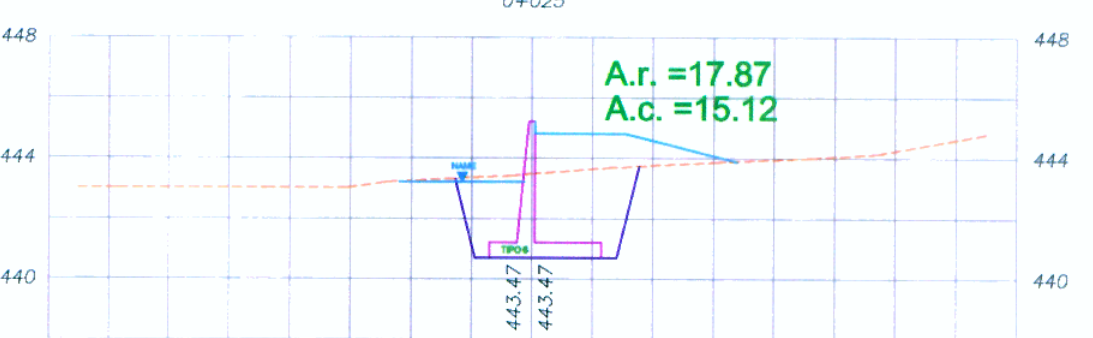
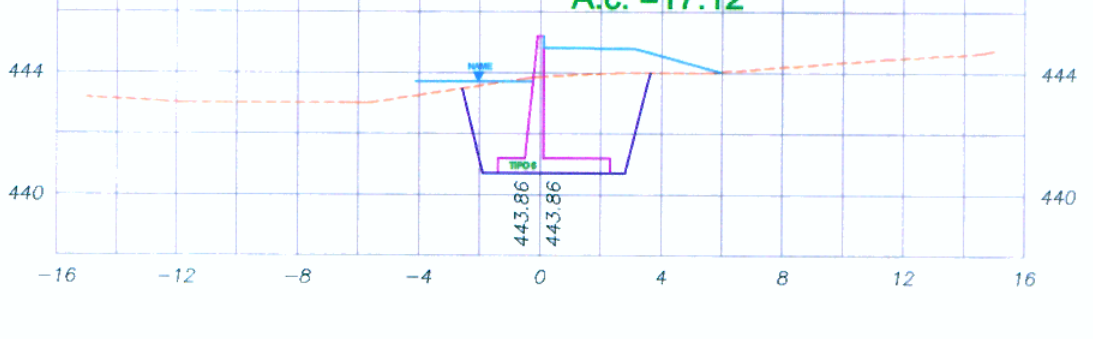
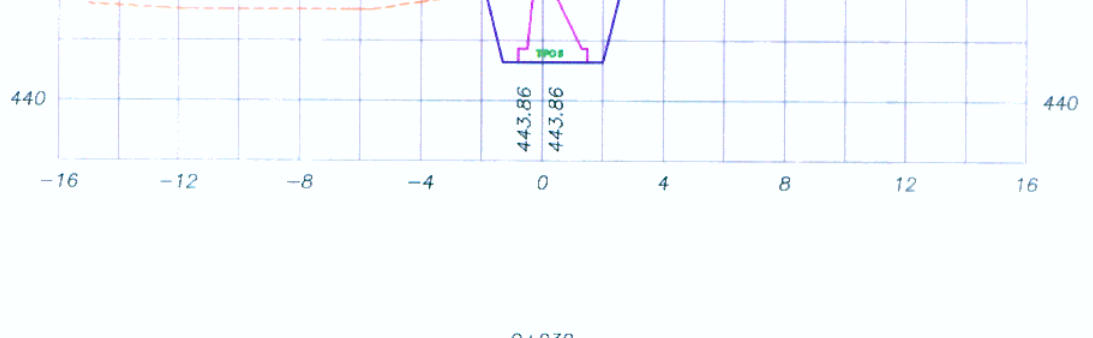
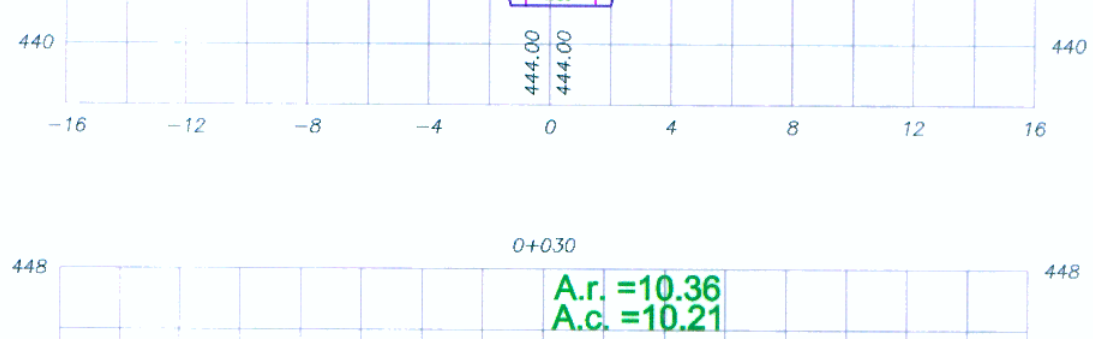
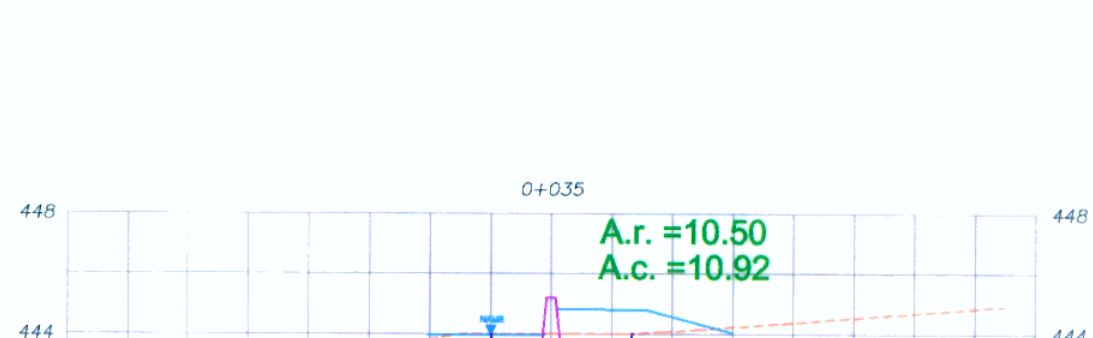
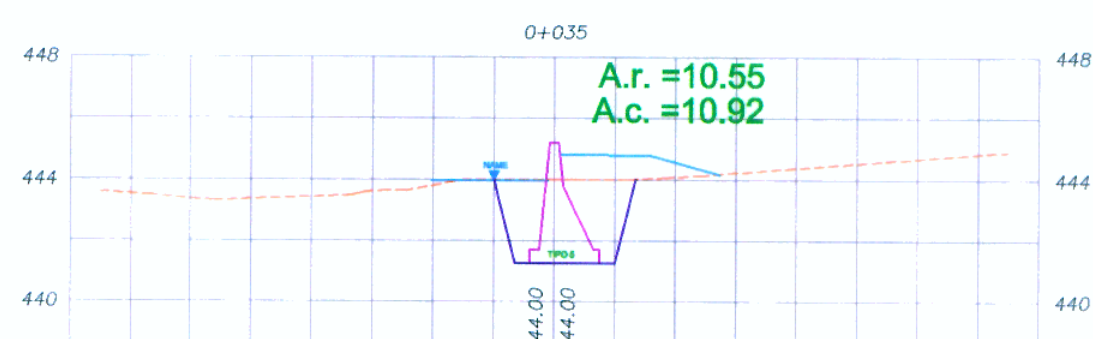
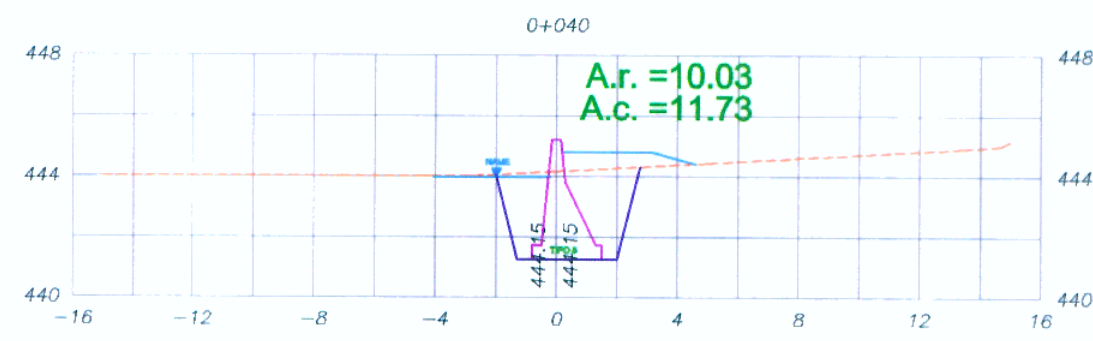
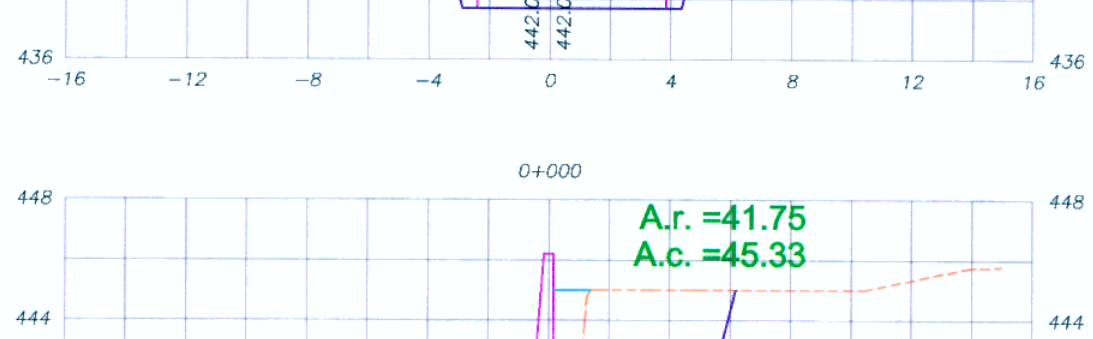
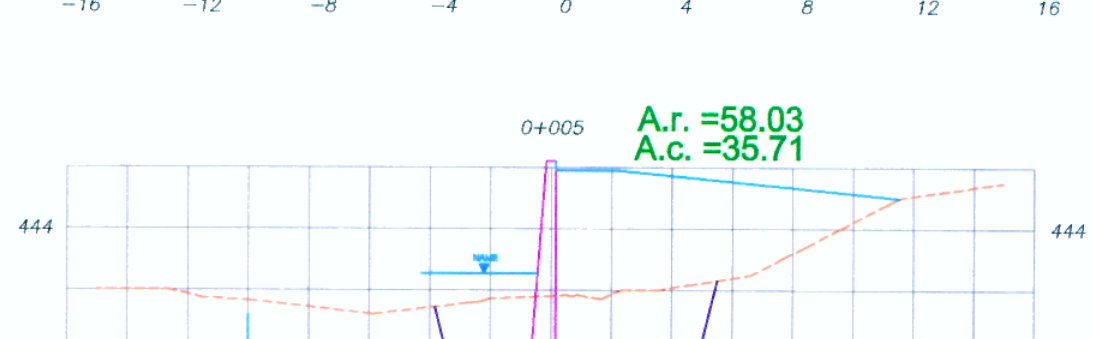
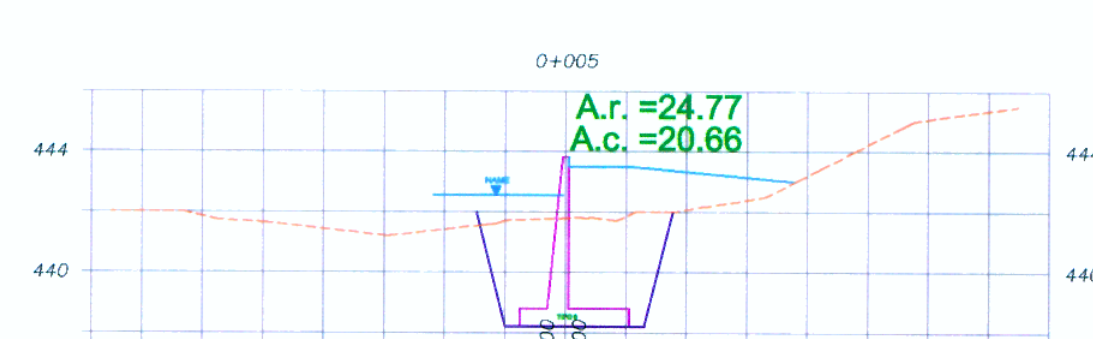
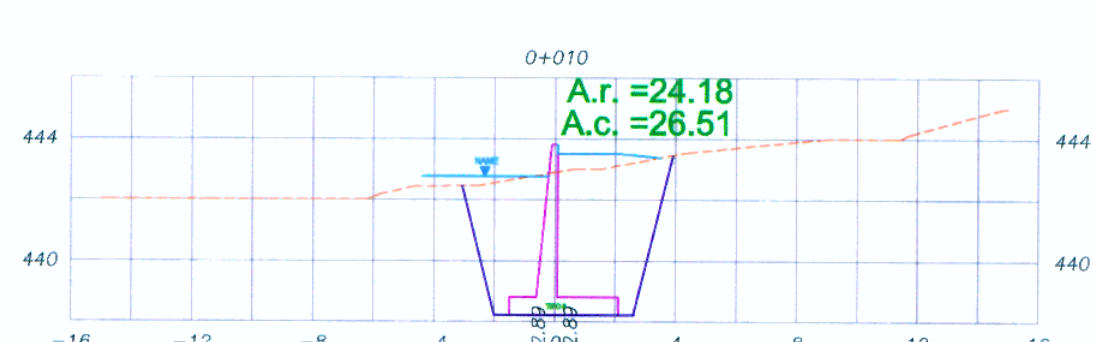
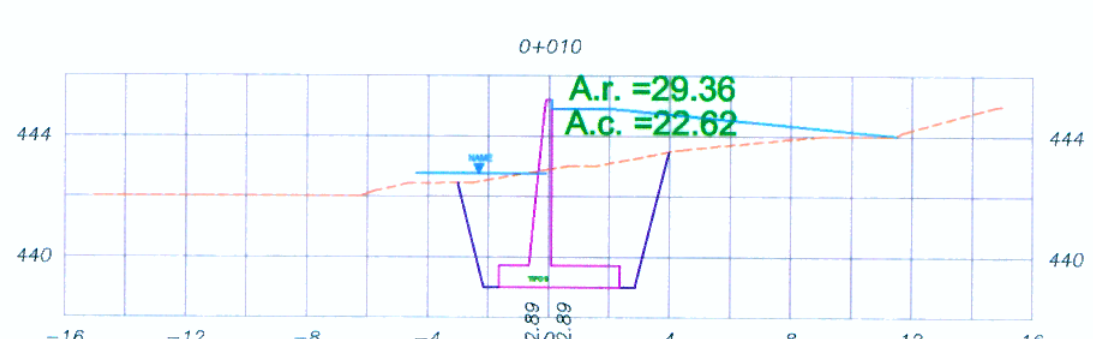
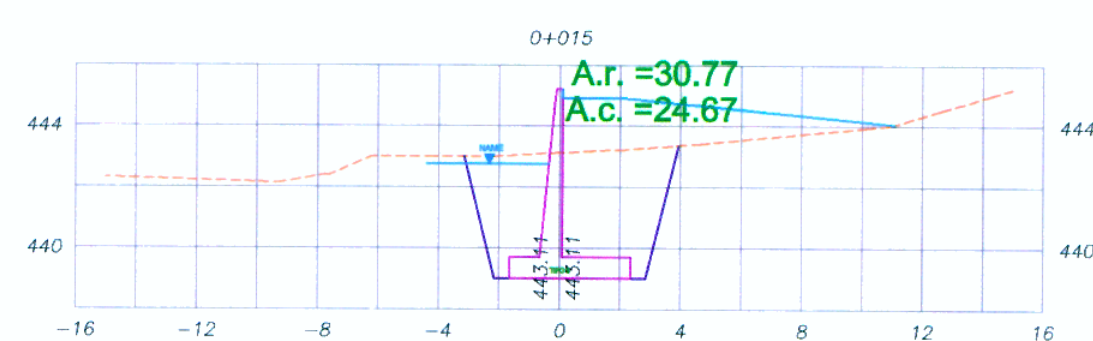
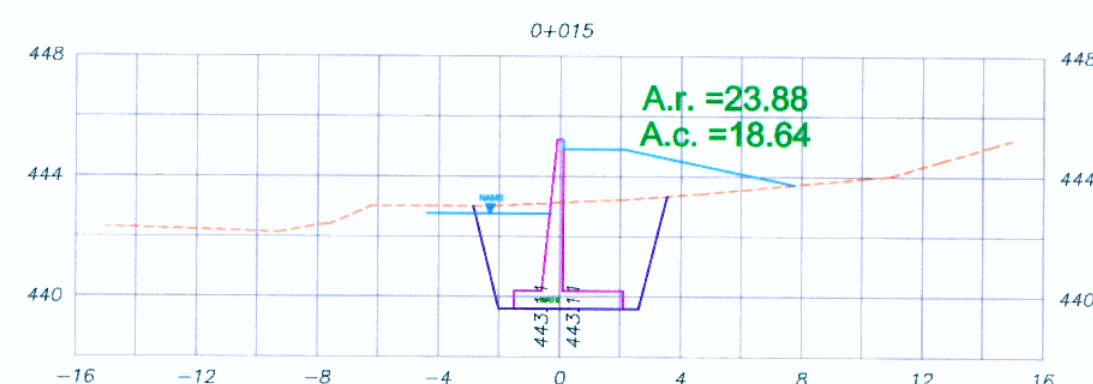
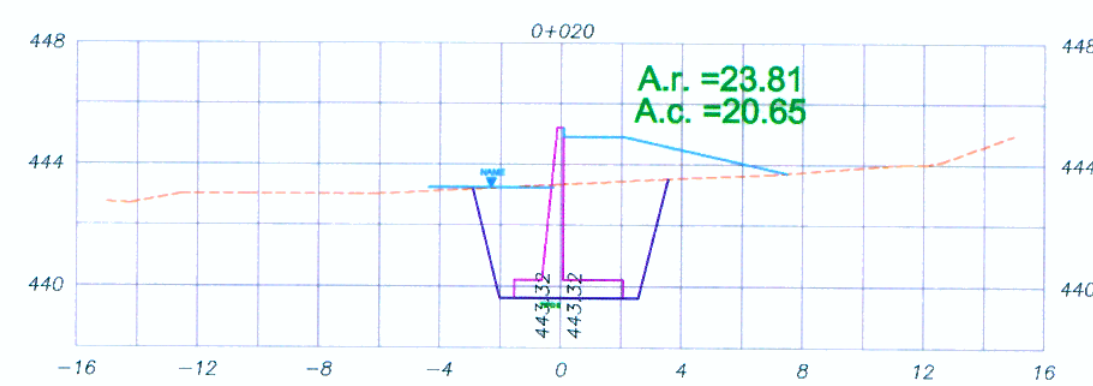

PROYECTISTA :

DISEÑO :  
DIBUJO : J. GONZALEZ  
REVISADO : J. SANDERA  
APROBADO :

APROBADO :

REVISIONES		
N°	FECHA	DESCRIPCION

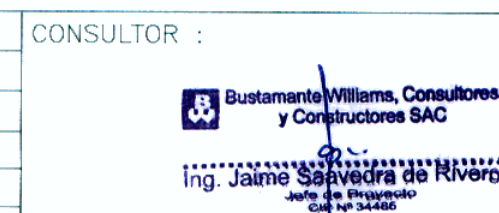

ESTUDIO DEFINITIVO DE LA CARRETERA CHAMAYA - JAJEN - SAN IGNACIO - RIO CANCHIS  
TRAMO: PERICOS - SAN IGNACIO  
SECCIONES TRANSVERSALES ENCAUZAMIENTO  
PONTON YUCARICA KM KM. 01+032.96

ESCALA : 1/250  
FECHA : ENERO-2011  
CODIGO : PT-01-L-14