

DEPOSITO DE MATERIAL EXCEDENTE
D.M.E. "Km 22+000"
LADO DER.

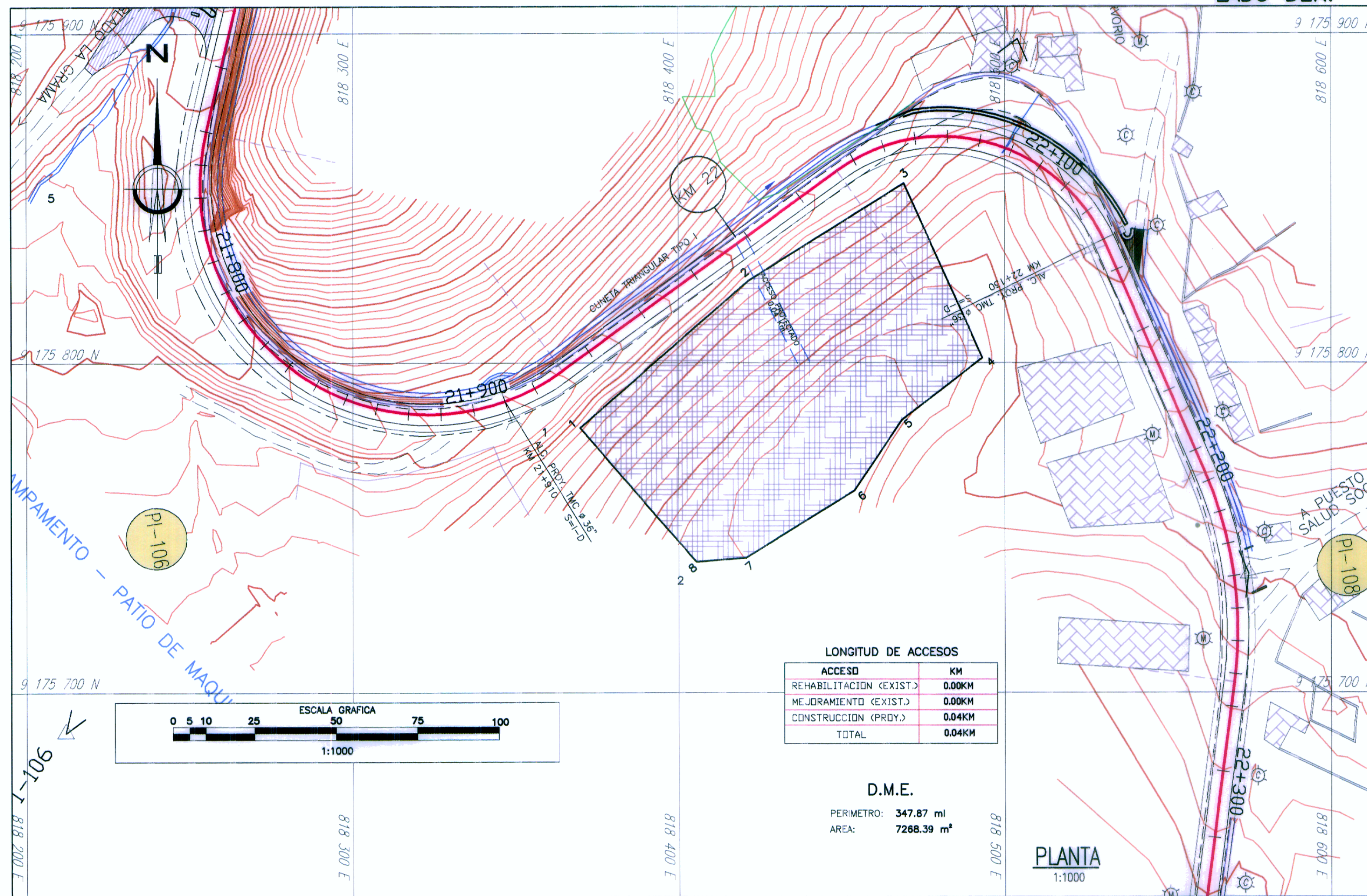

SECCIONES TRANSVERSALES
ESC. 1/500

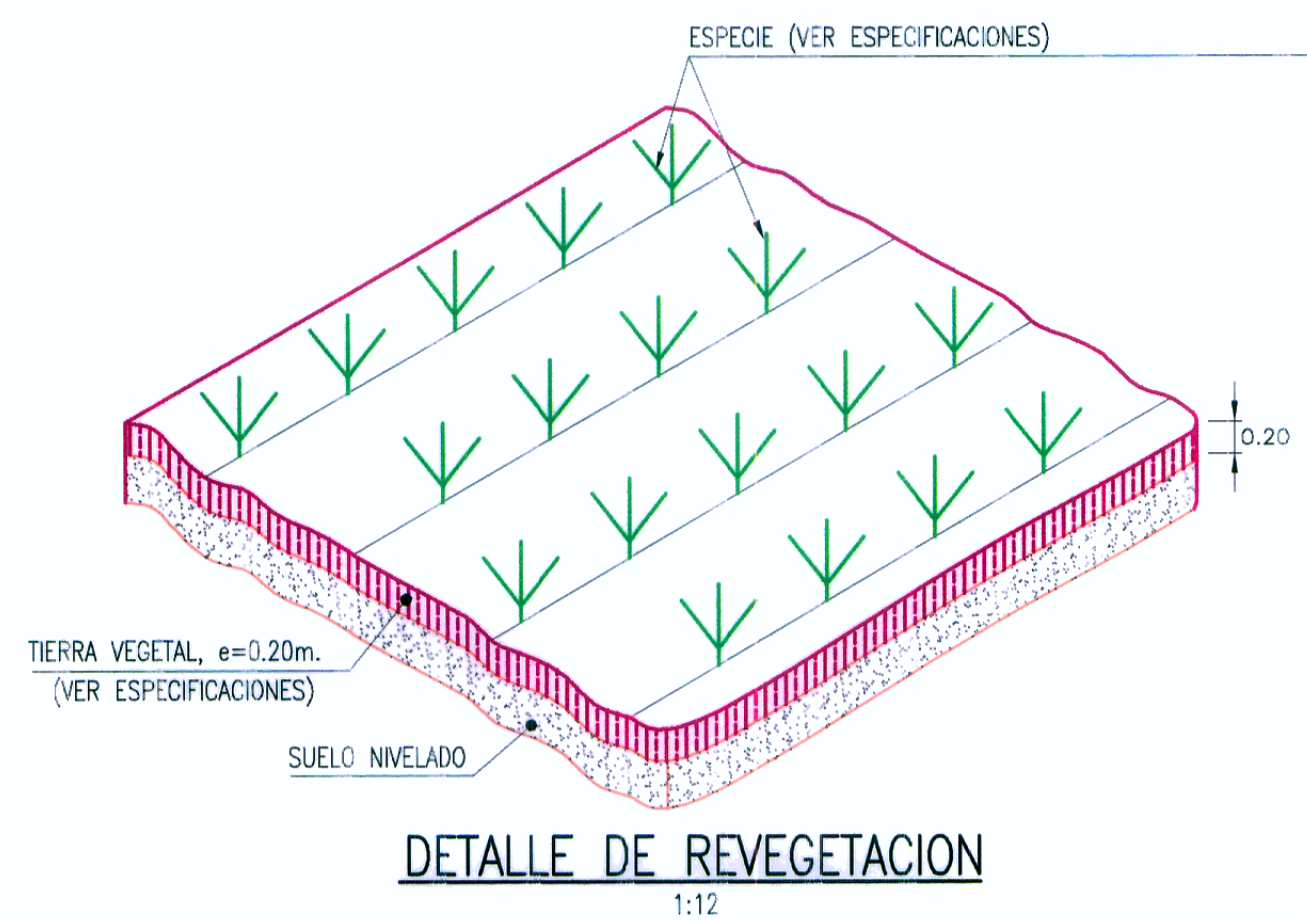
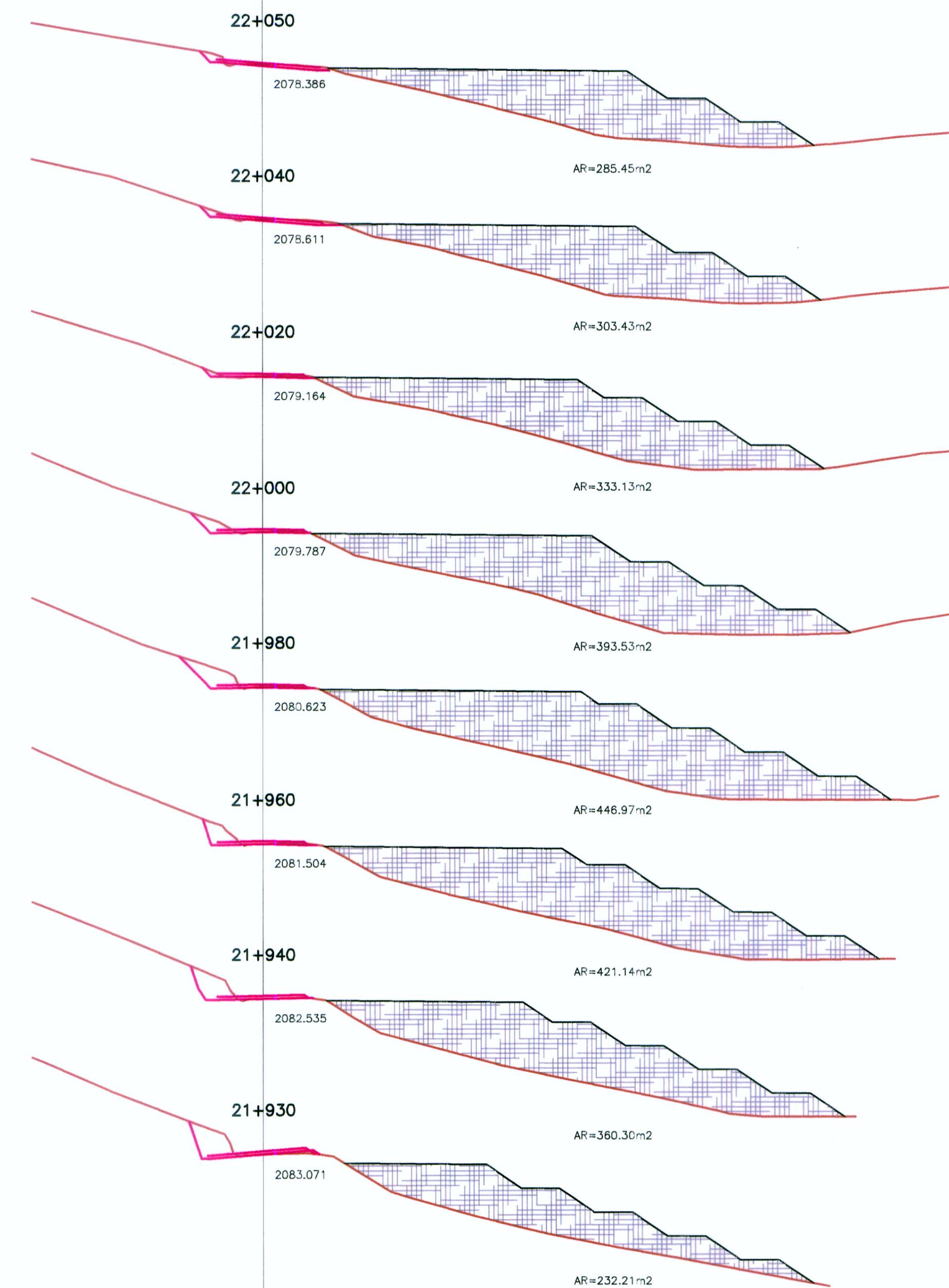

PROGRESIVAS	AREA m ²	VOLUMEN m ³
21+930	232.21	
21+940	360.30	2962.55
21+960	421.14	7814.40
21+980	446.97	8681.10
22+000	393.53	8405.00
22+020	333.13	7266.60
22+040	303.43	6365.60
22+050	285.45	2944.40
TOTAL		44,439.65

PV	NORTE	ESTE
1	9175780.28	818369.74
2	9175825.12	818421.46
3	9175854.75	818469.03
4	9175801.55	818493.07
5	9175782.64	818468.35
6	9175761.42	818453.89
7	9175741.10	818420.62
8	9175739.83	818405.38

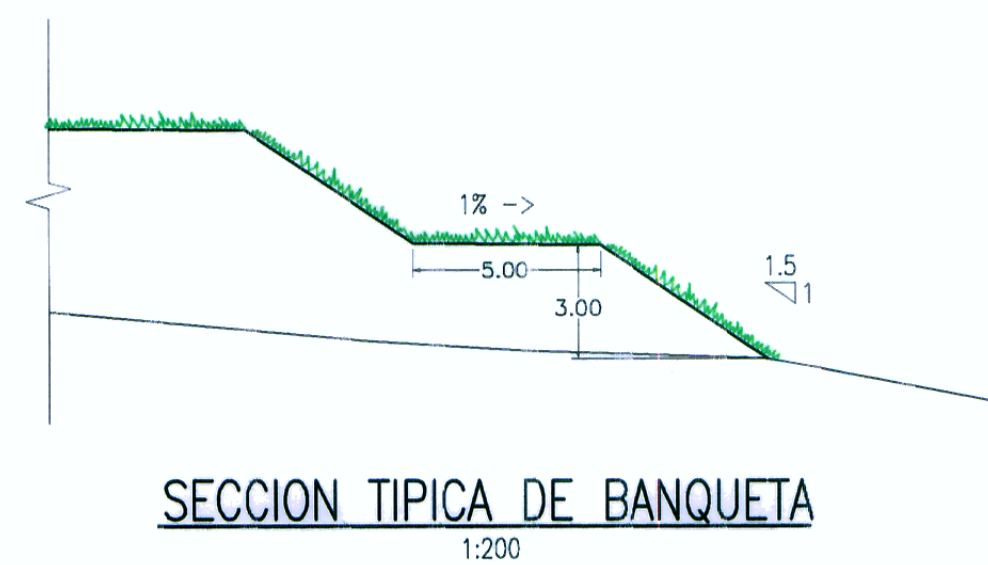

LEYENDA

PLANTA :

- EJE PROYECTADO
- CARRERA EXISTENTE
- CURVA MAYOR
- CURVA MENOR
- CASA

MATERIAL EXCEDENTE :

- VERTICE DE POLIGONAL
- AREA DE BOTADERO

HOB CONSULTORES S.A.
ING. FERNANDO MERUET VALDIVIA VARELA
EIV. IMPACTO AMBIENTAL
CIP N° 64157

HOB CONSULTORES S.A.
ING. CÉSAR EDISON GARCÍA MARIAPASTORA
EIV. IMPACTO AMBIENTAL
CIP N° 64157

N°	FECHA	DESCRIPCIÓN