

PLANTA
ESC : 1/2000

No. PI	ANGULO S	RADIO	PI	PC	PT	T	LC	EXT.	NORTE	ESTE	P%	S.A
28	0° 47' 04.75"	1,000.00	14+128.15	14+121.31	14+135.00	6.85	13.69	0.02	8,747,458.809	246,163.946	2.00	-
29	13° 20' 34.49"	750.00	14+382.35	14+294.62	14+469.28	87.73	174.66	5.11	8,747,683.804	246,282.235	2.00	0.30
30	9° 38' 06.61"	450.00	14+858.80	14+820.87	14+896.55	37.93	75.67	1.60	8,748,146.075	246,400.840	3.50	0.40

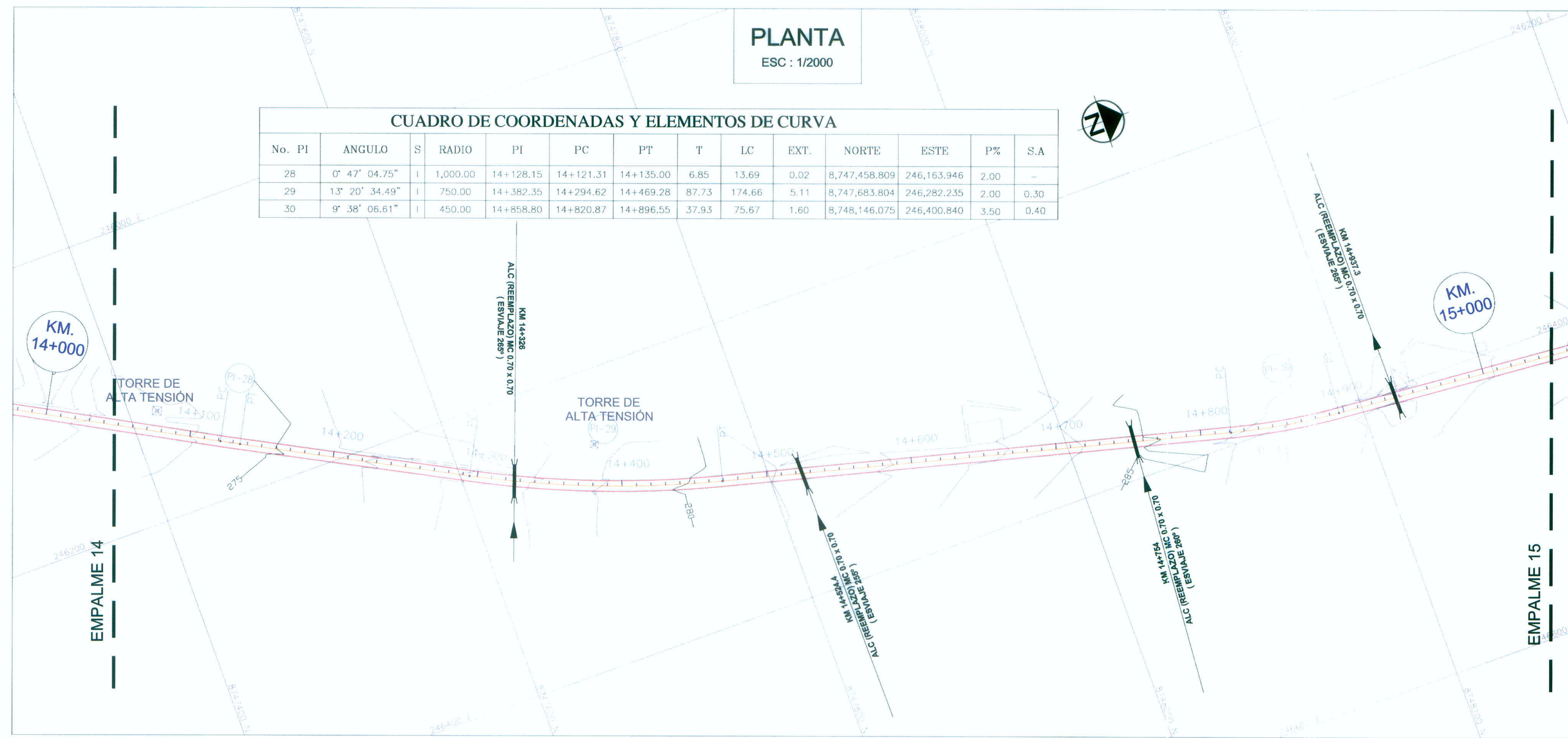

BM-14
271.145
14+060
Izq. A 7.00 m.

BM-14.5
274.969
14+524
Der. A 9.50 m.

BM-15
281.860
15+033
Izq. A 10.00 m.

PERFIL
ESC : H: 1/2000
ESC : V: 1/200

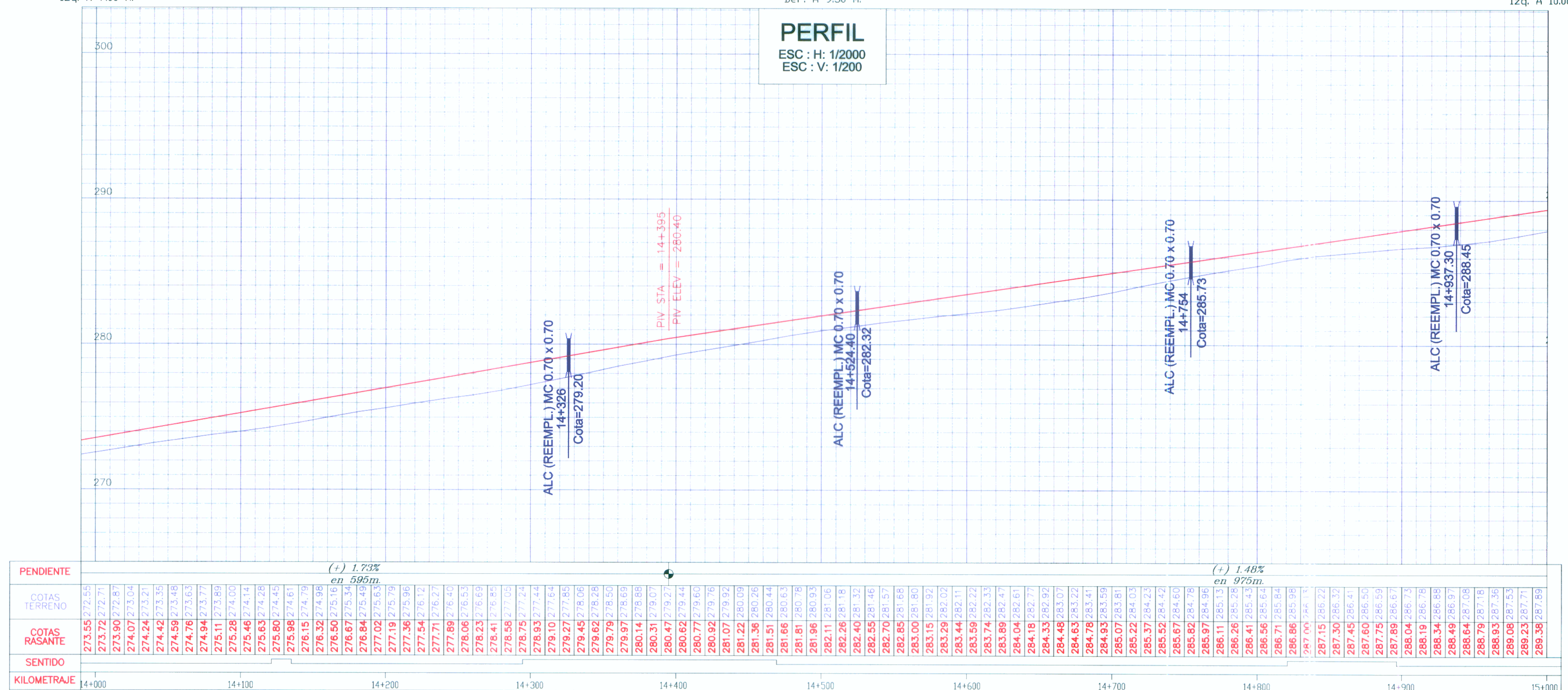

PENDIENTE	(+/-) 1.73% en 595m		(+/-) 1.48% en 976m	
	COTAS TERRENO	COTAS RASANTE	COTAS TERRENO	COTAS RASANTE
	273.55	272.55	273.55	272.55
	273.72	272.71	273.72	272.71
	273.90	272.89	273.90	272.89
	274.07	273.07	274.07	273.07
	274.24	273.24	274.24	273.24
	274.42	273.42	274.42	273.42
	274.59	273.59	274.59	273.59
	274.76	273.76	274.76	273.76
	274.94	273.94	274.94	273.94
	275.11	274.11	275.11	274.11
	275.28	274.28	275.28	274.28
	275.46	274.46	275.46	274.46
	275.63	274.63	275.63	274.63
	275.80	274.80	275.80	274.80
	275.98	274.98	275.98	274.98
	276.15	275.15	276.15	275.15
	276.32	275.32	276.32	275.32
	276.50	275.50	276.50	275.50
	276.67	275.67	276.67	275.67
	276.84	275.84	276.84	275.84
	277.02	276.02	277.02	276.02
	277.19	276.19	277.19	276.19
	277.36	276.36	277.36	276.36
	277.54	276.54	277.54	276.54
	277.71	276.71	277.71	276.71
	277.89	276.89	277.89	276.89
	278.06	277.06	278.06	277.06
	278.23	277.23	278.23	277.23
	278.41	277.41	278.41	277.41
	278.58	277.58	278.58	277.58
	278.75	277.75	278.75	277.75
	278.93	277.93	278.93	277.93
	279.10	278.10	279.10	278.10
	279.27	278.27	279.27	278.27
	279.45	278.45	279.45	278.45
	279.62	278.62	279.62	278.62
	279.79	278.79	279.79	278.79
	279.97	278.97	279.97	278.97
	280.14	279.14	280.14	279.14
	280.31	279.31	280.31	279.31
	280.47	279.47	280.47	279.47
	280.62	279.62	280.62	279.62
	280.77	279.77	280.77	279.77
	280.92	279.92	280.92	279.92
	281.07	280.07	281.07	280.07
	281.22	280.22	281.22	280.22
	281.36	280.36	281.36	280.36
	281.51	280.51	281.51	280.51
	281.66	280.66	281.66	280.66
	281.81	280.81	281.81	280.81
	281.96	280.96	281.96	280.96
	282.11	281.11	282.11	281.11
	282.26	281.26	282.26	281.26
	282.40	281.40	282.40	281.40
	282.55	281.55	282.55	281.55
	282.70	281.70	282.70	281.70
	282.85	281.85	282.85	281.85
	283.00	282.00	283.00	282.00
	283.15	282.15	283.15	282.15
	283.29	282.29	283.29	282.29
	283.44	282.44	283.44	282.44
	283.59	282.59	283.59	282.59
	283.74	282.74	283.74	282.74
	283.89	282.89	283.89	282.89
	284.04	283.04	284.04	283.04
	284.18	283.18	284.18	283.18
	284.33	283.33	284.33	283.33
	284.48	283.48	284.48	283.48
	284.63	283.63	284.63	283.63
	284.78	283.78	284.78	283.78
	284.93	283.93	284.93	283.93
	285.07	284.07	285.07	284.07
	285.22	284.22	285.22	284.22
	285.37	284.37	285.37	284.37
	285.52	284.52	285.52	284.52
	285.67	284.67	285.67	284.67
	285.82	284.82	285.82	284.82
	285.97	284.97	285.97	284.97
	286.11	285.11	286.11	285.11
	286.26	285.26	286.26	285.26
	286.41	285.41	286.41	285.41
	286.56	285.56	286.56	285.56
	286.71	285.71	286.71	285.71
	286.86	285.86	286.86	285.86
	287.00	286.00	287.00	286.00
	287.15	286.15	287.15	286.15
	287.30	286.30	287.30	286.30
	287.45	286.45	287.45	286.45
	287.60	286.60	287.60	286.60
	287.75	286.75	287.75	286.75
	287.89	286.89	287.89	286.89
	288.04	287.04	288.04	287.04
	288.19	287.19	288.19	287.19
	288.34	287.34	288.34	287.34
	288.49	287.49	288.49	287.49
	288.64	287.64	288.64	287.64
	288.79	287.79	288.79	287.79
	288.93	287.93	288.93	287.93
	289.08	288.08	289.08	288.08
	289.23	288.23	289.23	288.23
	289.38	288.38	289.38	288.38
	289.53	288.53	289.53	288.53
	289.68	288.68	289.68	288.68
	289.83	288.83	289.83	288.83
	289.98	288.98	289.98	288.98

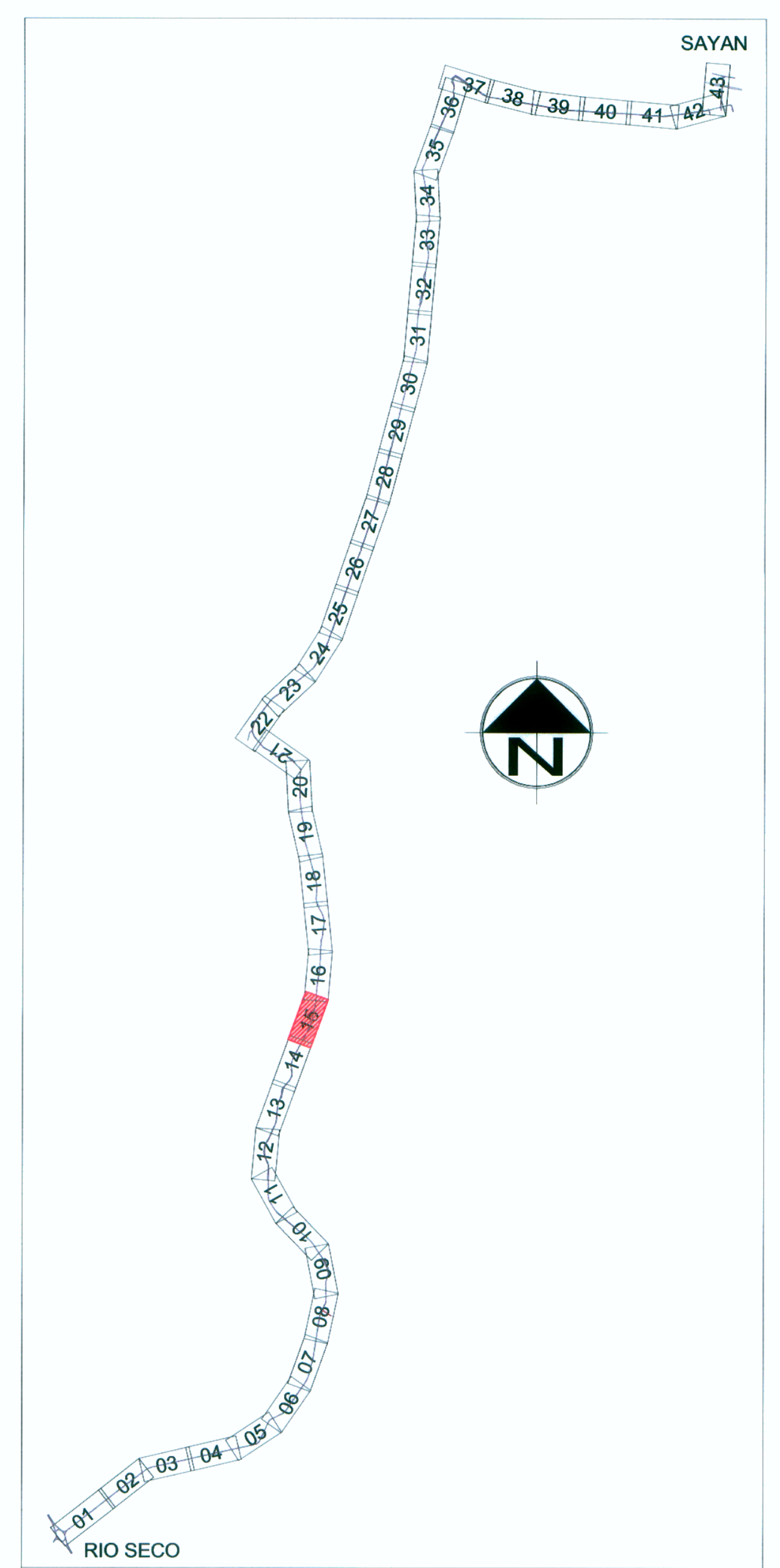

LEYENDA

VÍA PAVIMENTADA	CANAL DE TIERRA	VIVIENDA
DERECHO DE VÍA	VIVIENDA	POSTE DE LUZ
EJE	CANAL DE CONCRETO	POSTE DE TELÉFONO
CANAL DE CONCRETO	RASANTE DE PERFIL	POSTE DE MEDIA TENSION
RASANTE DE PERFIL	TERRENO DE PERFIL	PUENTE

FORMATO

FORMATO	ESCALA	GRÁFICA
A-1	1:200	0 2.00 4.00 6.00 8.00 10.00 m
A-1	1:2000	0 20.00 40.00 60.00 80.00 100.00 m
A-3	1:400	0 4.00 8.00 12.00 16.00 20.00 m
A-3	1:4000	0 40.00 80.00 120.00 160.00 200.00 m

ESTUDIO DEFINITIVO DEL PROYECTO REHABILITACION Y MEJORAMIENTO DE LA CARRETERA RIO SECO - EL AHORCADO - SAYAN

Ing. Hilario Huerta Oliviera
ESP EN TRAZO Y DISEÑO VIAL
C.I.P. 43202

ESTUDIO DEFINITIVO DEL PROYECTO REHABILITACION Y MEJORAMIENTO DE LA CARRETERA RIO SECO - EL AHORCADO - SAYAN

Ing. Hilario Huerta Oliviera
JEFE DE ESTUDIO
C.I.P. 43202