

PLANTA
ESC : 1/2000

CUADRO DE COORDENADAS Y ELEMENTOS DE CURVA													
No. PI	ANGULO	S	RADIO	PI	PC	PT	T	LC	EXT.	NORTE	ESTE	P%	S.A
36	30° 59' 53.56"	D	450.00	17+066.87	16+942.08	17+185.54	124.79	243.46	16.98	8,750,305.007	246,407.299	4.00	0.40
37	18° 44' 58.89"	I	520.00	17+429.02	17+343.17	17+513.33	85.85	170.17	7.04	8,750,672.791	246,426.119	2.00	0.30

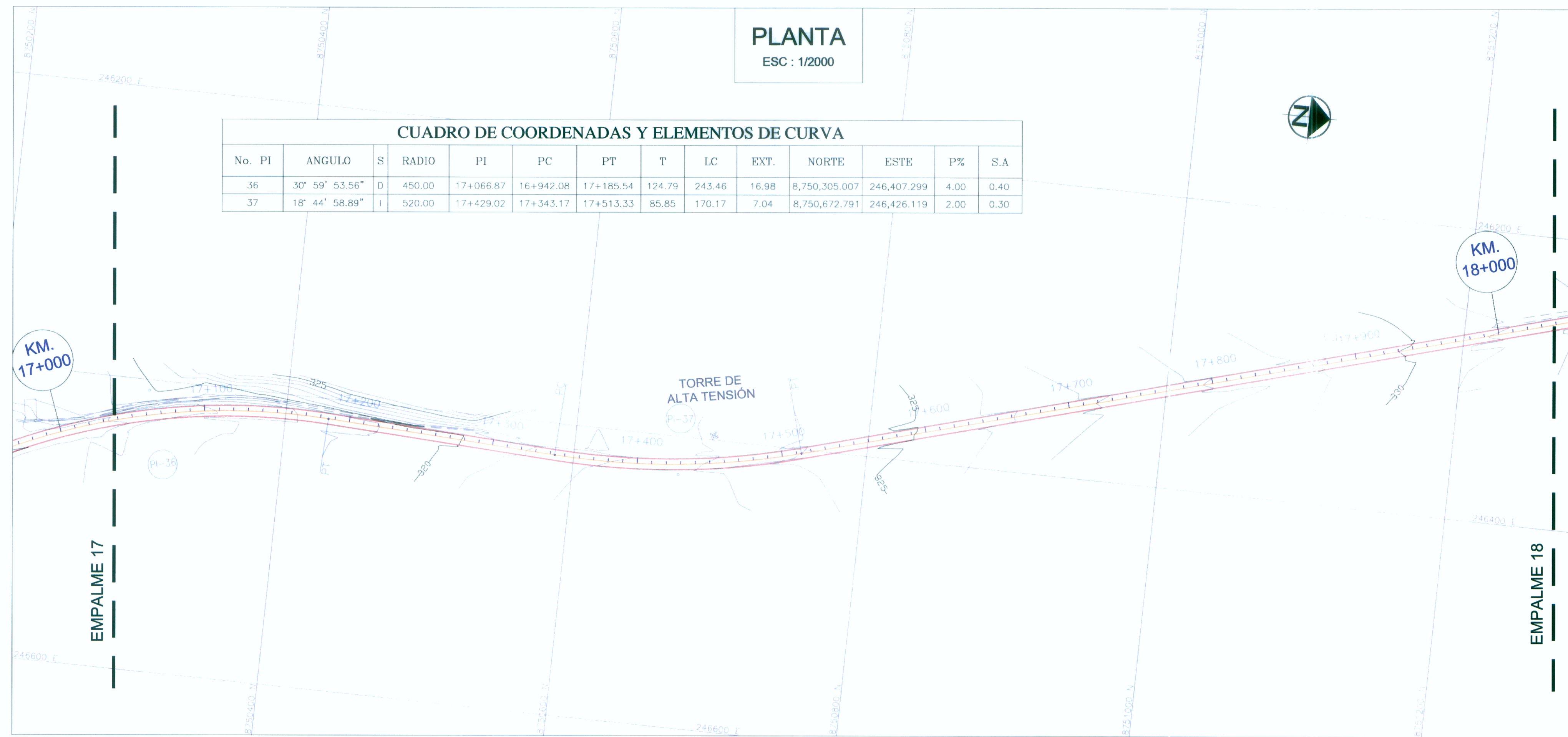

BM-17
315.779

16+990
Izq. A 8.00 m.

BM-17.5
319.506

17+455
Izq. A 7.00 m.

BM-18
326.788

18+002
Der. A 6.00 m.

PERFIL
ESC : H: 1/2000
ESC : V: 1/200

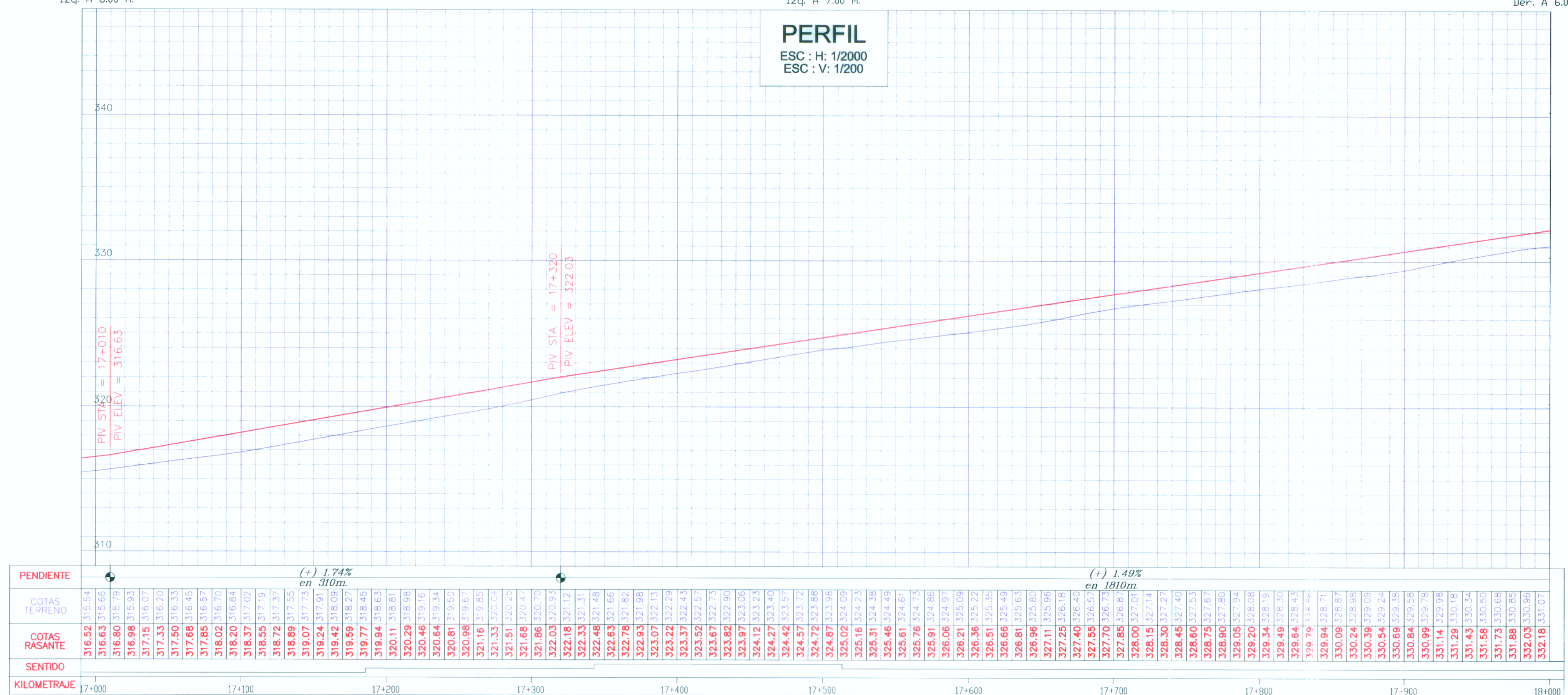

PENDIENTE	(+1) 1.74% en 310m														(+1) 1.49% en 1810m																	
	COTAS TERRENO	COTAS RASANTE	SENTIDO	KILOMETRAJE																												
	316.52	315.54		17+000																												
	316.63	315.66		17+100																												
	316.80	315.79		17+200																												
	316.98	315.93		17+300																												
	317.15	316.07		17+400																												
	317.33	316.20		17+500																												
	317.50	316.33		17+600																												
	317.68	316.45		17+700																												
	317.85	316.57		17+800																												
	318.02	316.70		17+900																												
	318.20	316.84		18+000																												
	318.37	317.02																														
	318.55	317.19																														
	318.72	317.37																														
	318.89	317.55																														
	319.07	317.73																														
	319.24	317.91																														
	319.42	318.09																														
	319.59	318.27																														
	319.77	318.45																														
	319.94	318.63																														
	320.11	318.81																														
	320.29	318.98																														
	320.46	319.16																														
	320.64	319.34																														
	320.81	319.50																														
	320.98	319.67																														
	321.16	319.85																														
	321.33	320.04																														
	321.51	320.24																														
	321.68	320.44																														
	321.86	320.64																														
	322.03	320.83																														
	322.18	321.02																														
	322.33	321.21																														
	322.48	321.41																														
	322.63	321.61																														
	322.78	321.82																														
	322.93	322.03																														
	323.07	322.23																														
	323.22	322.44																														
	323.37	322.65																														
	323.52	322.86																														
	323.67	323.07																														
	323.82	323.28																														
	323.97	323.49																														
	324.12	323.70																														
	324.27	323.91																														
	324.42	324.12																														
	324.57	324.33																														
	324.72	324.54																														
	324.87	324.75																														
	325.02	324.96																														
	325.16	325.17																														
	325.31	325.38																														
	325.46	325.59																														
	325.61	325.80																														
	325.76	326.01																														
	325.91	326.22																														
	326.06	326.43																														
	326.21	326.64																														
	326.36	326.85																														
	326.51	327.06																														
	326.66	327.27																														
	326.81	327.48																														
	326.96	327.69																														
	327.11	327.90																														
	327.25	328.11																														
	327.40	328.32																														
	327.55	328.53																														
	327.70	328.74																														
	327.85	328.95																														
	328.00	329.16																														
	328.15	329.37																														
	328.30	329.58																														
	328.45	329.79																														
	328.60	330.00																														
	328.75	330.21																														
	328.90	330.42																														
	329.05	330.63																														
	329.20	330.84																														
	329.34	331.05																														
	329.49	331.26																														
	329.64	331.47																														
	329.79	331.68																														
	329.94	331.89																														
	330.09	332.10																														
	330.24	332.31																														
	330.39	332.52																														
	330.54	332.73																														
	330.69	332.94																														
	330.84	333.15																														
	330.99	333.36																														
	331.14	333.57																														
	331.29	333.78																														
	331.43	333.99																														
	331.58	340.20																														
	331.73	334.08																														
	331.88	334.29																														
	332.03	334.50																														
	332.18	334.71																														
	332.31	334.92																														

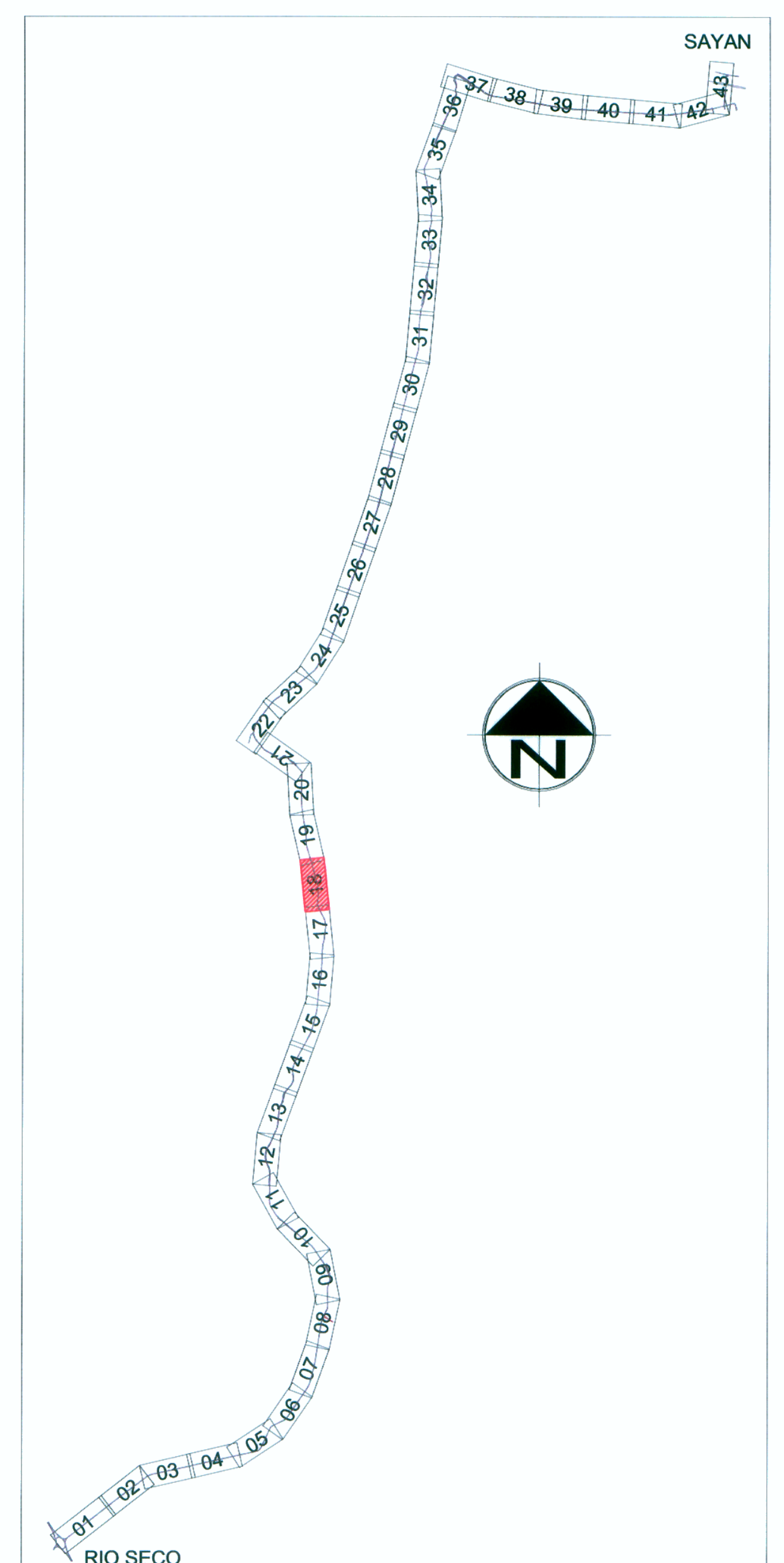

LEYENDA

VÍA PAVIMENTADA	---	CANAL DE TIERRA	---
DERECHO DE VIA	---	VIVIENDA	---
EJE	---	POSTE DE LUZ	---
CANAL DE CONCRETO	---	POSTE DE TELÉFONO	---
RASANTE DE PERFIL	---	POSTE DE MEDIA TENSION	---
TERRENO DE PERFIL	---	PUENTE	---

FORMATO

FORMATO	ESCALA GRÁFICA						
	1:200	0	2.00	4.00	6.00	8.00	10.00 m
A-1	1:2000	0	20.00	40.00	60.00	80.00	100.00 m
A-3	1:400	0	4.00	8.00	12.00	16.00	20.00 m
	1:4000	0	40.00	80.00	120.00	160.00	200.00 m

ESTUDIO DEFINITIVO DEL PROYECTO REHABILITACION Y MEJORAMIENTO DE LA CARRETERA RIO SECO - EL AHORCADO - SAYAN

Ing. Hilario Huerta Olvera
ESP EN TRAZO Y DISEÑO VIAL
C.I.P. 43202