

PLANTA
ESC : 1/2000

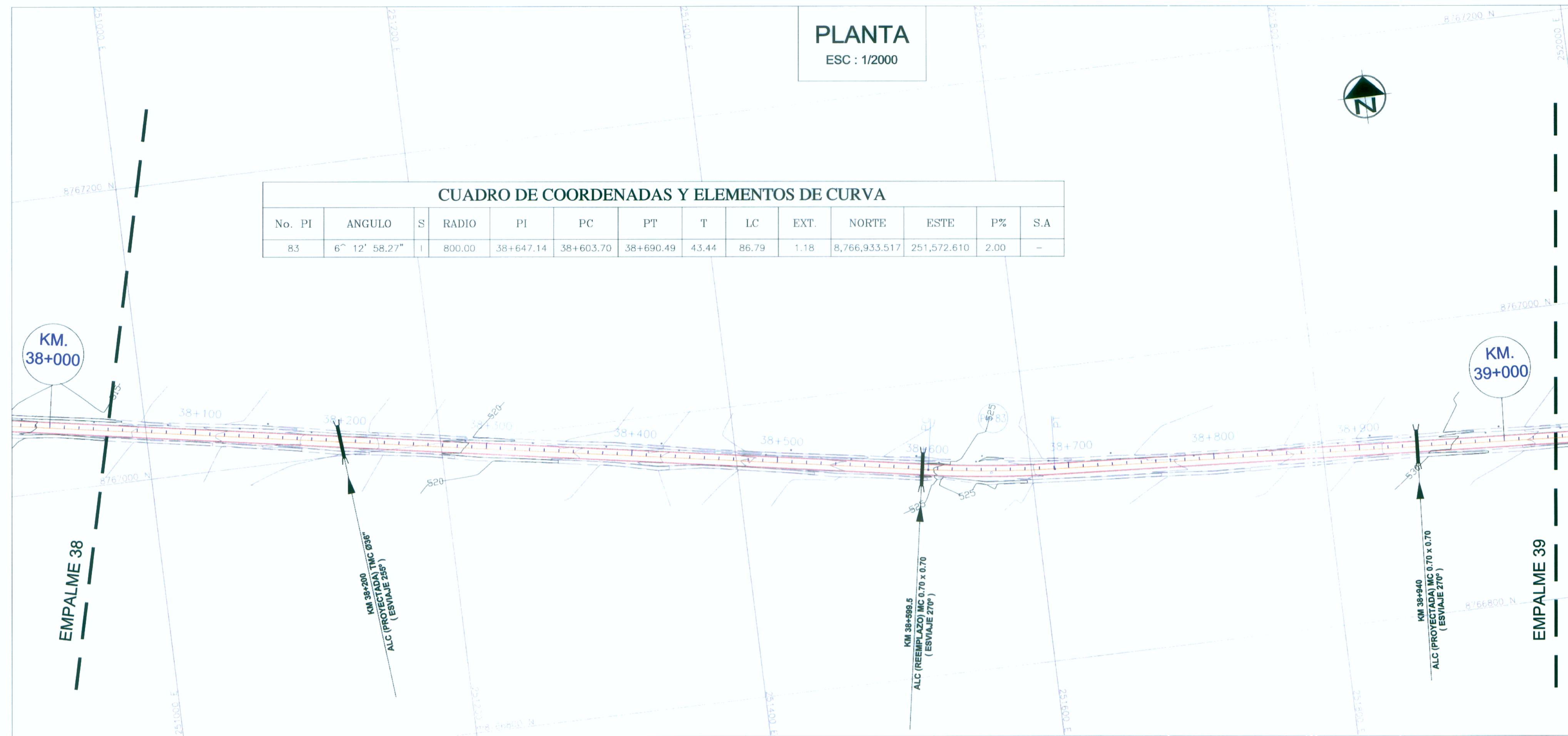

CUADRO DE COORDENADAS Y ELEMENTOS DE CURVA

No. PI	ANGULO S	RADIO	PI	PC	PT	T	LC	EXT.	NORTE	ESTE	P%	S.A
8.3	6° 12' 58.27"	800.00	38+647.14	38+603.70	38+690.49	43.44	86.79	1.18	8,766,933.517	251,572.610	2.00	-

BM-38
514.856
37+969
Izq. A 10.50 m.

BM-38.5
523.424
38+509
Izq. A 9.50 m.

BM-39
531.337
39+000
Izq. A 8.00 m.

PERFIL
ESC : H: 1/2000
ESC : V: 1/200

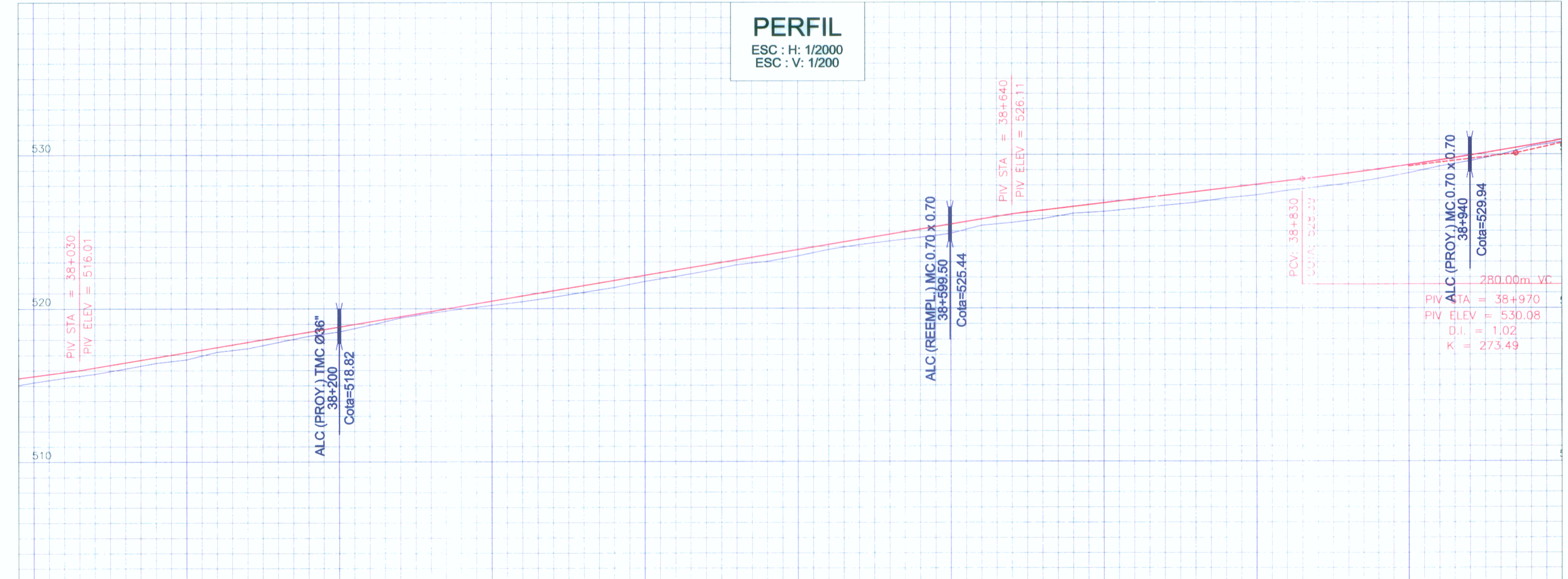

PENDIENTE	(+/-) 1.66% en 610m		(+/-) 1.20% en 330m	
	COTAS TERRENO	COTAS RASANTE	SENTIDO	KILOMETRAJE
	515.62	515.21		38+000
	515.75	515.36		
	515.88	515.50		
	516.01	515.63		
	516.14	515.76		
	516.27	515.89		
	516.40	516.02		
	516.53	516.15		
	516.66	516.28		
	516.79	516.41		
	516.92	516.54		
	517.05	516.67		
	517.18	516.80		
	517.31	516.93		
	517.44	517.06		
	517.57	517.19		
	517.70	517.32		
	517.83	517.45		
	517.96	517.58		
	518.09	517.71		
	518.22	517.84		
	518.35	517.97		
	518.48	518.10		
	518.61	518.23		
	518.74	518.36		
	518.87	518.49		
	519.00	518.62		
	519.13	518.75		
	519.26	518.88		
	519.39	519.01		
	519.52	519.14		
	519.65	519.27		
	519.78	519.40		
	519.91	519.53		
	520.04	519.66		
	520.17	519.79		
	520.30	519.92		
	520.43	520.05		
	520.56	520.18		
	520.69	520.31		
	520.82	520.44		
	520.95	520.57		
	521.08	520.70		
	521.21	520.83		
	521.34	520.96		
	521.47	521.09		
	521.60	521.22		
	521.73	521.35		
	521.86	521.48		
	521.99	521.61		
	522.12	521.74		
	522.25	521.87		
	522.38	522.00		
	522.51	522.13		
	522.64	522.26		
	522.77	522.39		
	522.90	522.52		
	523.03	522.65		
	523.16	522.78		
	523.29	522.91		
	523.42	523.04		
	523.55	523.17		
	523.68	523.30		
	523.81	523.43		
	523.94	523.56		
	524.07	523.69		
	524.20	523.82		
	524.33	523.95		
	524.46	524.08		
	524.59	524.21		
	524.72	524.34		
	524.85	524.47		
	524.98	524.60		
	525.11	524.73		
	525.24	524.86		
	525.37	524.99		
	525.50	525.12		
	525.63	525.25		
	525.76	525.38		
	525.89	525.51		
	526.02	525.64		
	526.15	525.77		
	526.28	525.90		
	526.41	526.03		
	526.54	526.16		
	526.67	526.29		
	526.80	526.42		
	526.93	526.55		
	527.06	526.68		
	527.19	526.81		
	527.32	526.94		
	527.45	527.07		
	527.58	527.20		
	527.71	527.33		
	527.84	527.46		
	527.97	527.59		
	528.10	527.72		
	528.23	527.85		
	528.36	527.98		
	528.49	528.11		
	528.62	528.24		
	528.75	528.37		
	528.88	528.50		
	529.01	528.63		
	529.14	528.76		
	529.27	528.89		
	529.40	529.02		
	529.53	529.15		
	529.66	529.28		
	529.79	529.41		
	529.92	529.54		
	530.05	529.67		
	530.18	529.80		
	530.31	529.93		
	530.44	530.06		
	530.57	530.19		
	530.70	530.32		
	530.83	530.45		
	530.96	530.58		
	531.09	530.71		
	531.22	530.84		
	531.35	530.97		
	531.48	531.10		
	531.61	531.23		
	531.74	531.36		
	531.87	531.49		
	532.00	531.62		
	532.13	531.75		
	532.26	531.88		
	532.39	532.01		
	532.52	532.14		
	532.65	532.27		
	532.78	532.40		
	532.91	532.53		
	533.04	532.66		
	533.17	532.79		
	533.30	532.92		
	533.43	533.05		
	533.56	533.18		
	533.69	533.31		
	533.82	533.44		
	533.95	533.57		
	534.08	533.70		
	534.21	533.83		
	534.34	533.96		
	534.47	534.09		
	534.60	534.22		
	534.73	534.35		
	534.86	534.48		
	534.99	534.61		
	535.12	534.74		
	535.25	534.87		
	535.38	535.00		
	535.51	535.13		
	535.64	535.26		
	535.77	535.39		
	535.90	535.52		
	536.03	535.65		
	536.16	535.78		
	536.29	535.91		
	536.42	536.04		
	536.55	536.17		
	536.68	536.30		
	536.81	536.43		
	536.94	536.56		
	537.07	536.69		
	537.20	536.82		
	537.33	536.95		
	537.46	537.08		
	537.59	537.21		
	537.72	537.34		
	537.85	537.47		
	537.98	537.60		
	538.11	537.73		
	538.24	537.86		
	538.37	537.99		
	538.50	538.12		
	538.63	538.25		
	538.76	538.38		
	538.89	538.51		
	539.02	538.64		
	539.15	538.77		
	539.28	538.90		
	539.41	539.03		
	539.54	539.16		
	539.67	539.29		
	539.80	539.42		
	539.93	539.55		
	540.06	539.68		
	540.19	539.81		
	540.32	539.94		
	540.45	540.07		
	540.58	540.20		
	540.71	540.33		
	540.84	540.46		
	540.97	540.59		
	541.10	540.72		
	541.23	540.85		
	541.36	540.98		
	541.49	541.11		
	541.62	541.24		
	541.75	541.37		
	541.88	541.50		
	542.01	541.63		
	542.14	541.76		
	542.27	541.89		
	542.40	542.02		
	542.53	542.15		
	542.66	542.28		
	542.79	542.41		
	542.92	542.54		
	543.05	542.67		
	543.18	542.80		
	543.31	542.93		
	543.44	543.06		
	543.57	543.19		
	543.70	543.32		
	543.83	543.45		
	543.96	543.58		
	544.09	543.71		
	544.22	543.84		
	544.35	543.97		
	544.48	544.10		
	544.61	544.23		
	544.74	544.36		
	544.87	544.49		
	545.00	544.62		
	545.13	544.75		
	545.26	544.88		
	545.39	545.01		
	545.52	545.14		
	545.65	545.27		
	545.78	545.40		
	545.91	545.53		
	546.04	545.66		
	546.17	545.79		
	546.30	545.92		
	546.43	546.05		
	546.56	546.18		
	546.69	546.31		
	546.82	546.44		
	546.95	546.57		
	547.08	546.70		
	547.21	546.83		
	547.34	546.96		
	547.47	547.09		