

Nº PI	ANGULO	S	RADIO (m)	PC (Km)	PT (Km)	T (m)	LC (m)	EXT (m)	PER (%)	S/a (m)
67	23°27'09"	I	200.00	15+382.57	15+444.44	41.51	81.87	4.26	5.80%	0.60
68	54°45'13"	D	83.00	15+531.34	15+610.65	42.98	79.32	10.47	7.97%	1.80
69	40°42'09"	I	124.00	15+758.69	15+846.78	46.00	88.09	8.26	7.28%	1.10
70	31°58'23"	D	124.00	15+956.00	16+025.20	35.52	69.20	4.99	7.28%	1.10

Nº PI	KM	COORDENADAS	
		NORTE	ESTE
67	15+404.09	873798.89	328398.17
68	15+574.32	8737915.28	328523.98
69	15+804.68	8737868.09	328755.63
70	15+991.53	8737957.75	328923.1

**PLANTA**  
H: 1/2,000

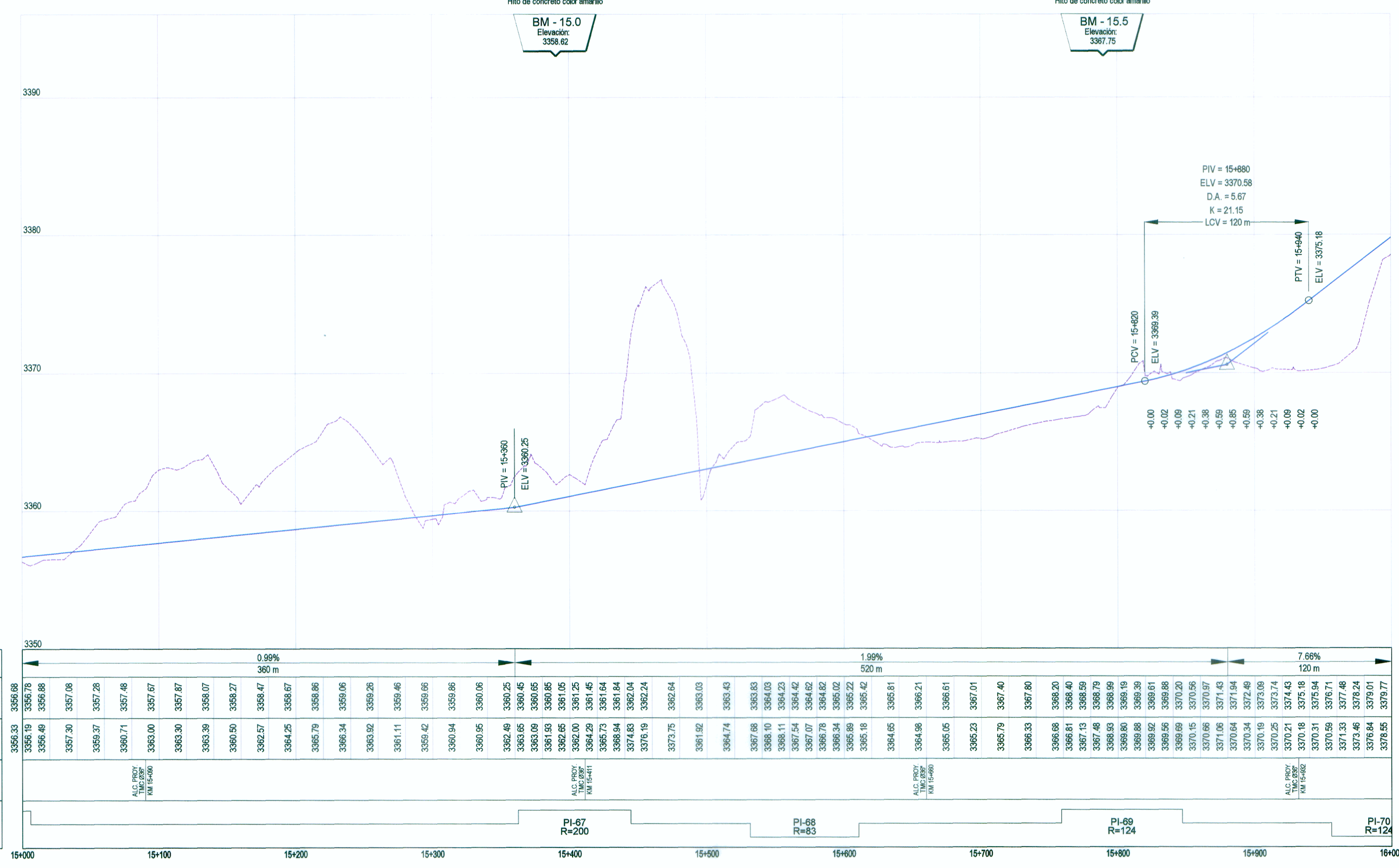

<b>PLANTA:</b>	
	EJE DE CARRETERA PROYECTADA
	CARRETERA EXISTENTE
	CURVA AGOSTOR
	CURVA MENOR
	RIOS Y LAGUNAS
	QUEBRADA
	CANAL
	ALCANTARILLAS PROYECTADAS
	VIVIENDA EXISTENTE
	TERRENO DE CULTIVO
	CERCO
	POSTE LUZ
	POSTE TELEFONO
	MURO DE PIEDRA
	BOFEDAL
	PLAZOLETAS
	NUMERO DE CURVA
<b>PERFIL:</b>	
	SUB RASANTE
	TERRENO EXISTENTE

PENDIENTE	COTA DE SUB RASANTE	COTA DE TERRENO	OBRAS DE ARTE	ALINEAMIENTO
	3356.88	3356.33		15+000
	3356.78	3356.19		15+100
	3356.88	3356.49		15+200
	3357.08	3357.30		15+300
	3357.28	3357.37		15+400
	3357.48	3357.71		15+500
	3357.67	3358.00		15+600
	3357.87	3358.30		15+700
	3358.07	3358.39		15+800
	3358.27	3358.50		15+900
	3358.47	3358.57		16+000
	3358.67	3358.25		
	3358.86	3358.49		
	3359.06	3358.65		
	3359.26	3358.79		
	3359.46	3358.94		
	3359.66	3359.09		
	3359.86	3359.24		
	3359.03	3359.39		
	3359.43	3359.54		
	3359.83	3359.69		
	3360.23	3359.84		
	3360.64	3359.99		
	3361.04	3360.14		
	3361.45	3360.29		
	3361.85	3360.44		
	3362.25	3360.59		
	3362.65	3360.74		
	3363.05	3360.89		
	3363.45	3361.04		
	3363.85	3361.19		
	3364.25	3361.34		
	3364.65	3361.49		
	3365.05	3361.64		
	3365.45	3361.79		
	3365.85	3361.94		
	3366.25	3362.09		
	3366.65	3362.24		
	3367.05	3362.39		
	3367.45	3362.54		
	3367.85	3362.69		
	3368.25	3362.84		
	3368.65	3362.99		
	3369.05	3363.14		
	3369.45	3363.29		
	3369.85	3363.44		
	3370.25	3363.59		
	3370.65	3363.74		
	3371.05	3363.89		
	3371.45	3364.04		
	3371.85	3364.19		
	3372.25	3364.34		
	3372.65	3364.49		
	3373.05	3364.64		
	3373.45	3364.79		
	3373.85	3364.94		
	3374.25	3365.09		
	3374.65	3365.24		
	3375.05	3365.39		
	3375.45	3365.54		
	3375.85	3365.69		
	3376.25	3365.84		
	3376.65	3365.99		
	3377.05	3366.14		
	3377.45	3366.29		
	3377.85	3366.44		
	3378.25	3366.59		
	3378.65	3366.74		
	3379.05	3366.89		
	3379.45	3367.04		
	3379.85	3367.19		
	3380.25	3367.34		

**PERFIL LONGITUDINAL**  
H: 1/2,000 V: 1/200