

DEPOSITO DE MATERIAL EXCEDENTE
D.M.E. "Km 28+060"
LADO IZQ.

SECCIONES TRANSVERSALES
ESC. 1/500

291

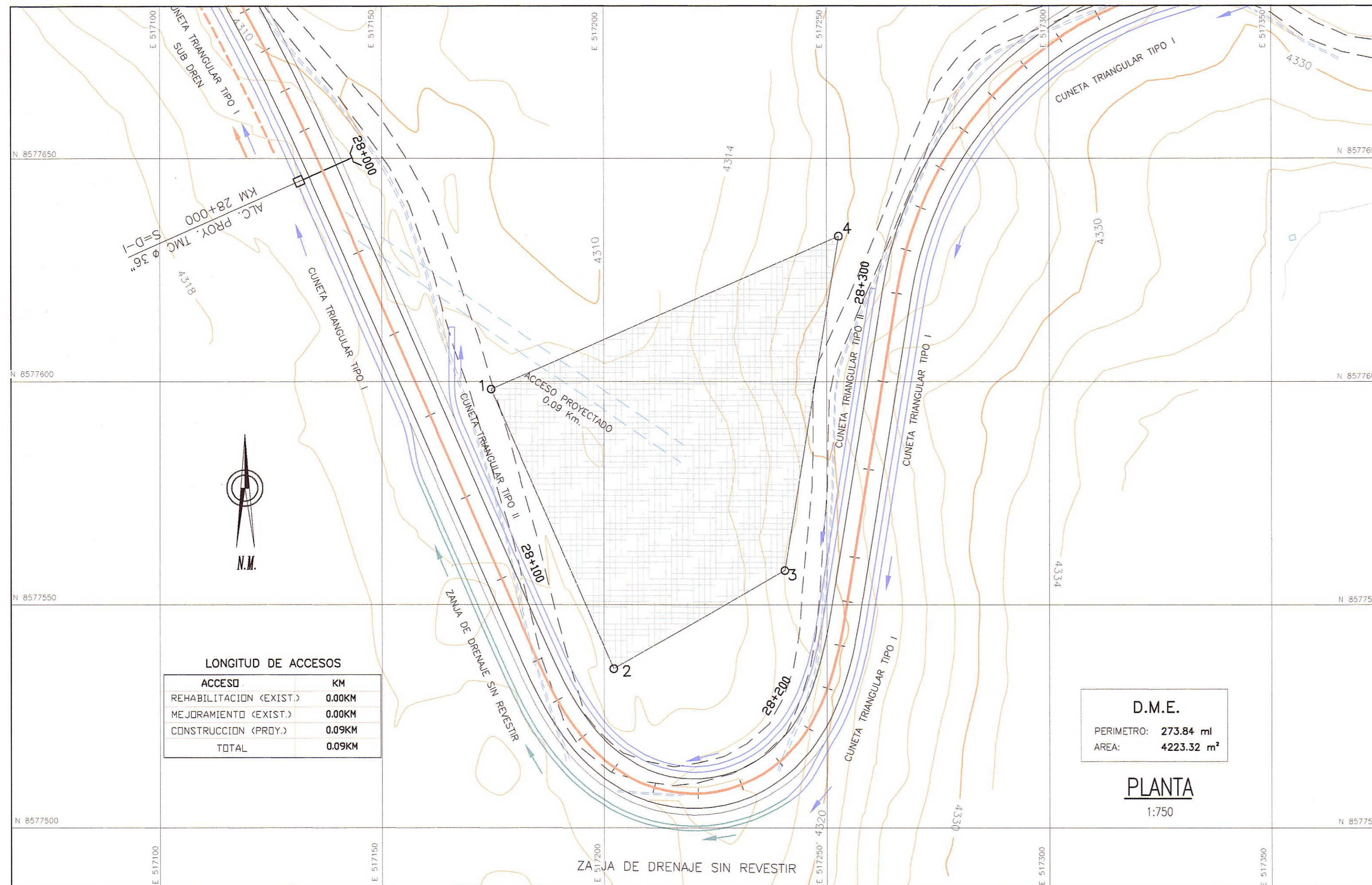

D.M.E.
PERIMETRO: 273.84 ml
AREA: 4223.32 m²
PLANTA
1:750

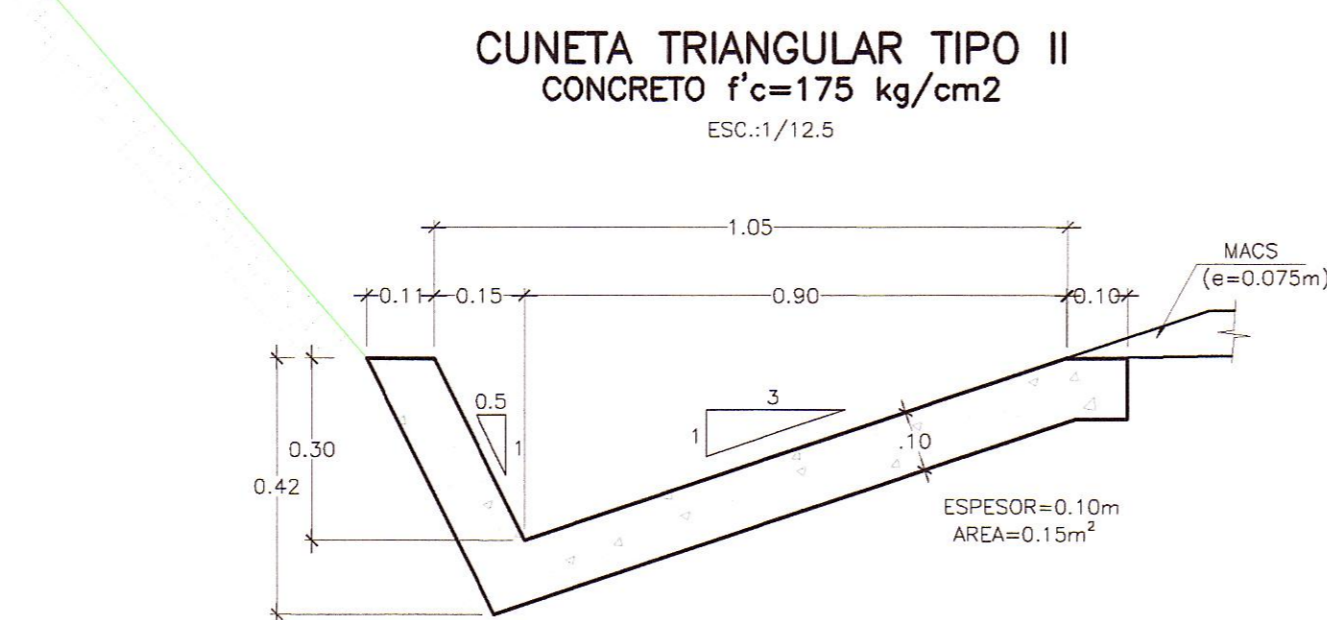
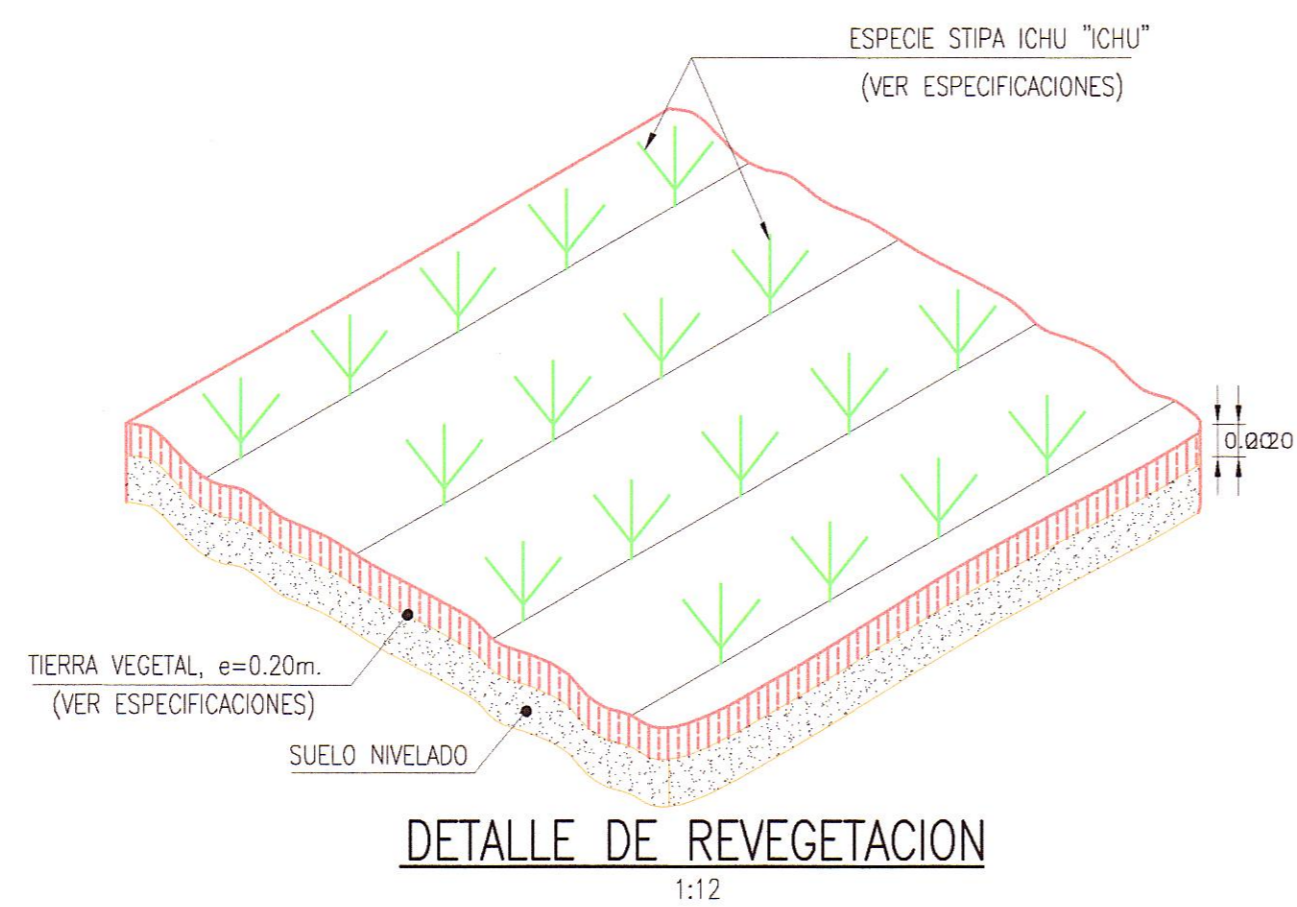
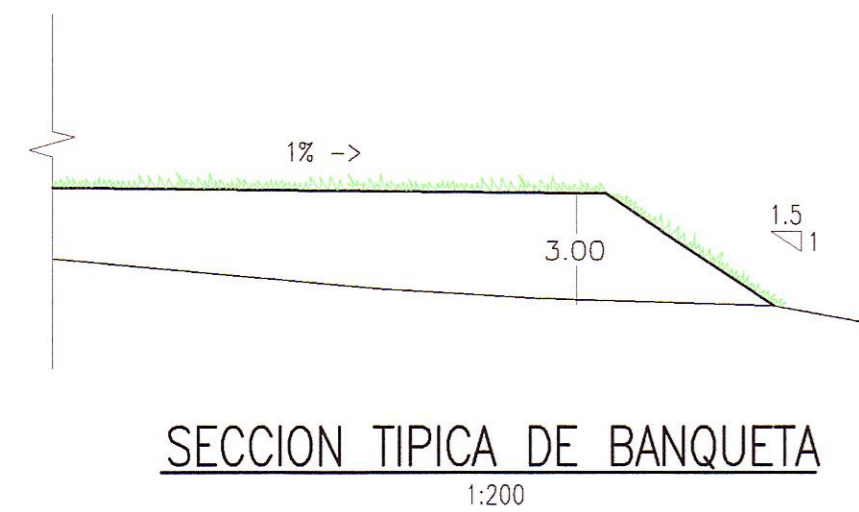
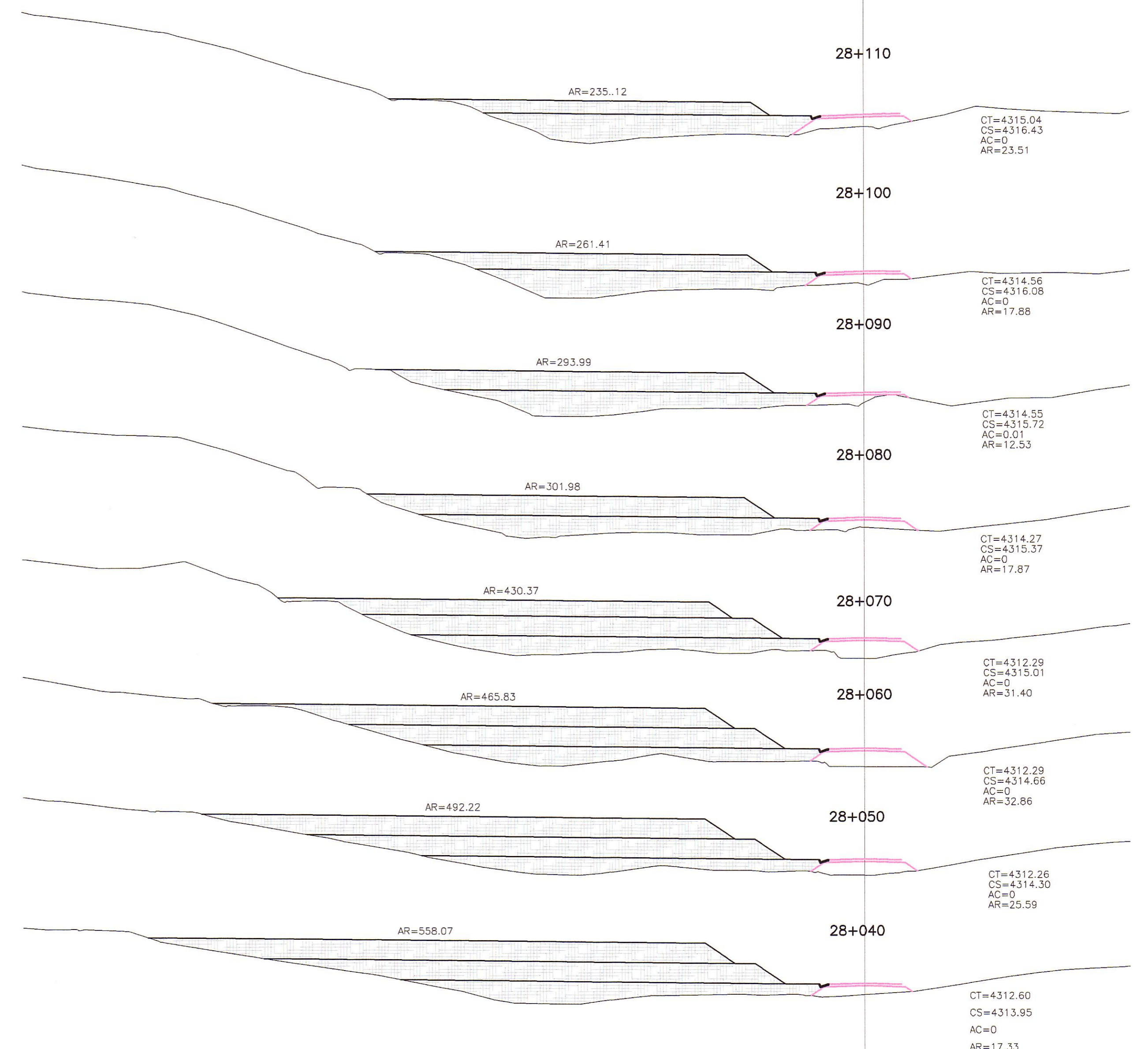

CALCULO DE CAPACIDAD		
PROGRESIVAS	AREA m ²	VOLUMEN m ³
28+040	558.07	
28+050	492.22	5251.45
28+060	465.83	4790.25
28+070	430.37	4481.00
28+080	301.98	3661.75
28+090	293.99	2979.85
28+100	261.41	2777.00
28+110	235.12	2482.65
TOTAL		26423.95

CUADRO DE COORDENADAS UTM		
PV	NORTE	ESTE
1	8577598.244	517174.604
2	8577535.645	517202.118
3	8577557.660	517240.594
4	8577632.556	517252.667

FOTO DME KM 28+060



LEYENDA	
PLANTA :	
—	EJE PROYECTADO
—	CARRETERA EXISTENTE
—	CURVA MAYOR
—	CURVA MENOR
□	CASA
MATERIAL EXCEDENTE :	
○	VERTICE DE POLIGONAL
□	AREA DE D.M.E.