

**DETALLE DE BARANDA - PUENTES
ESC.: 1/10**

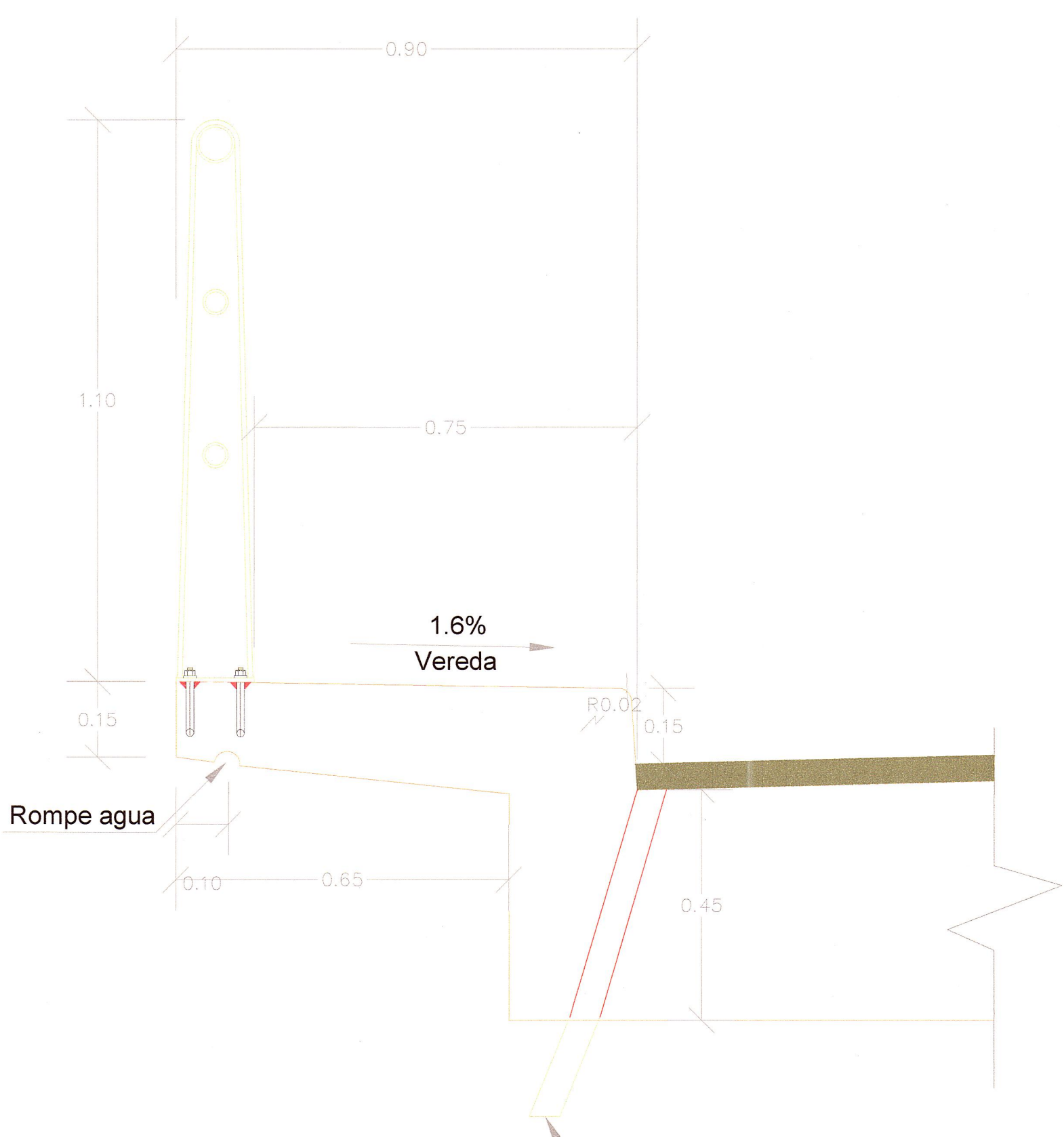

**MODULOS COMPLEMENTARIOS DE
BARANDA EN EXTREMOS**

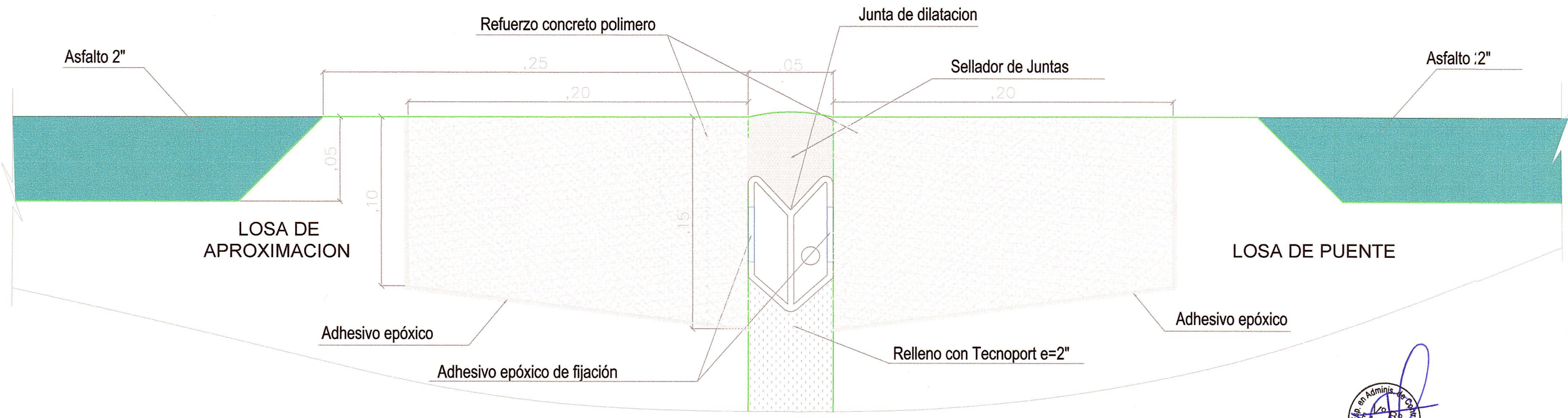
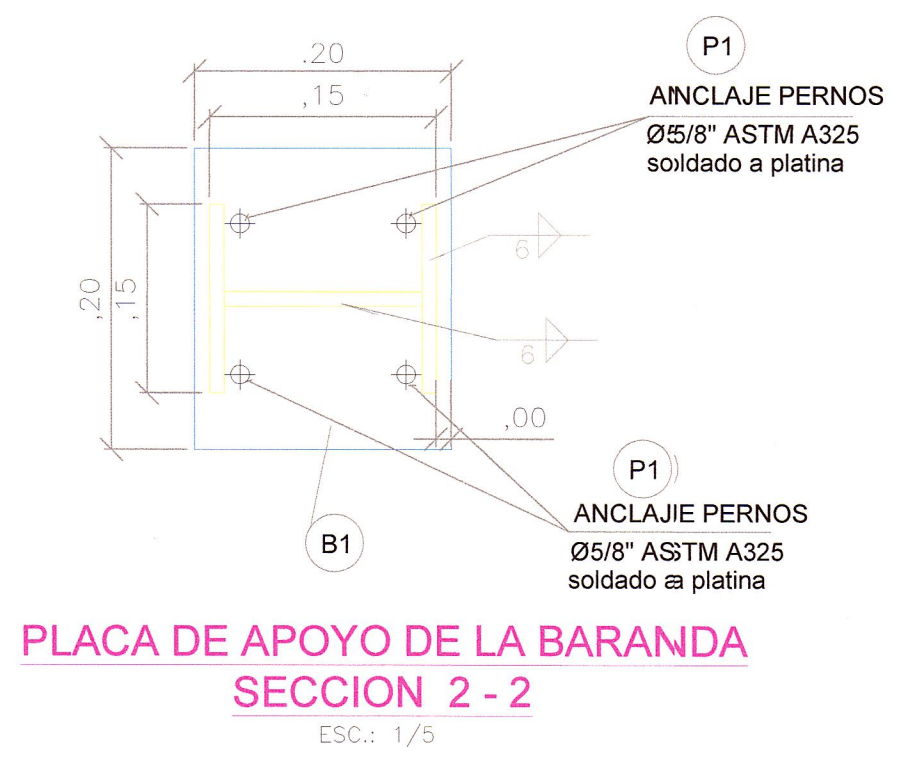
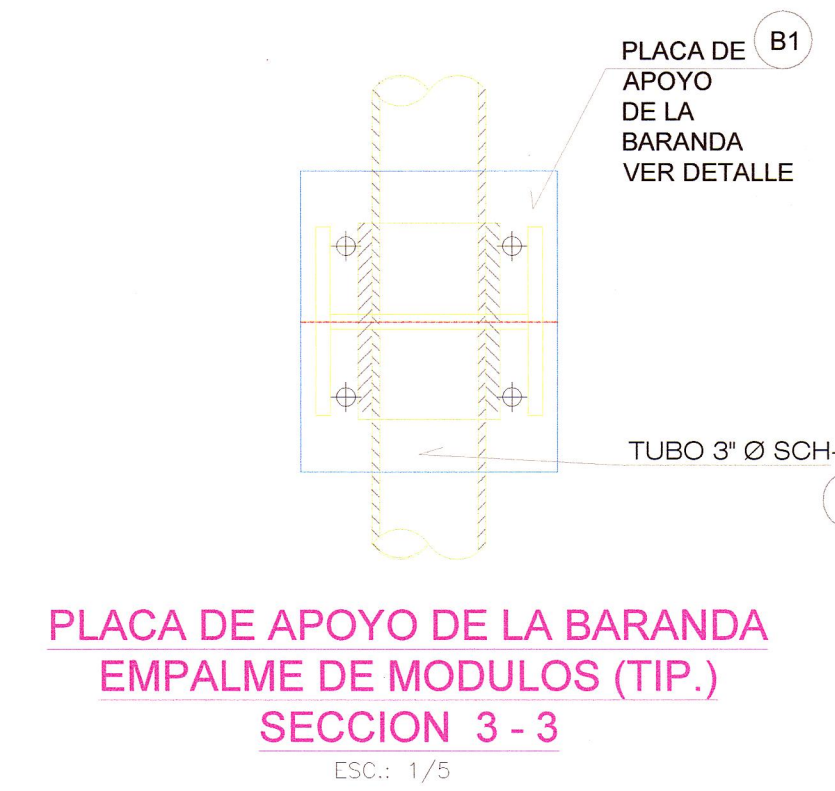
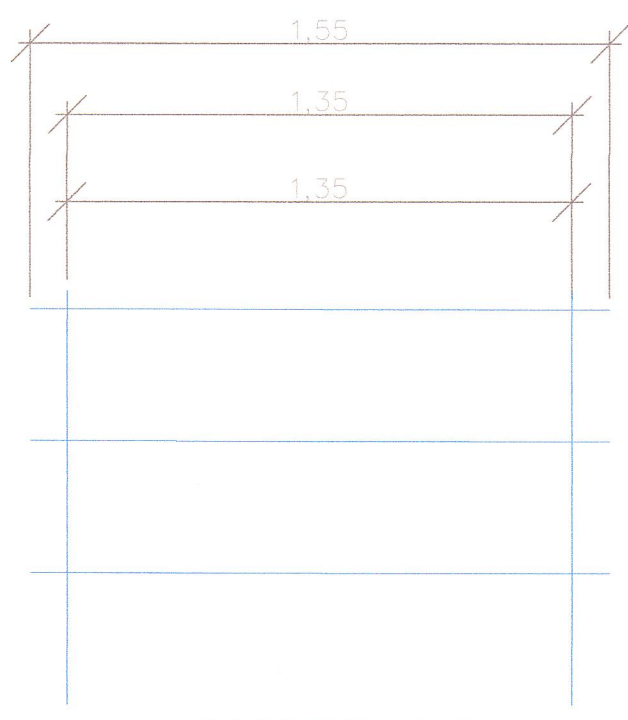

ESPECIFICACIONES PARA BARANDAS	
COLUMNAS METALICAS DE BARANDA SECCION I PLT e=3/8"	ASTM A242 Gr50
PLACA DE APOYO PLT. 5/8" x .20 x .17	ASTM A242 Gr50
PERNOS PARA ANCLAJE Ø5/8"	ASTM A325
SOLDADURA AWS D1.1 E7018 o similar	

JNR Consultores S.A.
 Javier Francisco Tinje Carbajal
 Esp. Estructuras
 Ing. Civil CIP No 52356

JNR CONSULTORES S.A.
 Ing. ENRIQUE COX CASSINELLI
 Jefe de Proyecto
 C.I.P. 22654